

IB250400
INDUCTIVE SENSORS • NORM SWITCHING DISTANCE

sensor inductive, 50x10x25mm, Flush, Sn: 5, 10-30V DC, PNP NO,
Cable 2m PVC, IP67, PA 6.6 (synthetic), Static

MECHANICAL FEATURES

| | |
|--|----------------------|
| Active area material of sensor | PA 6.6 (synthetic) |
| Ambient temperature | -25 °C ... 70 °C |
| Cable infeed | Axial |
| Cable length | 2 m |
| Degree of protection (IP) | IP67 |
| Design | Cuboid |
| Housing material | PA 6.6 (synthetic) |
| Material of cable sheath | PVC |
| Mechanical mounting condition for sensor | Flush |
| Number of cores | 4 |
| Pressure-proof | - |
| Sensor height | 50 mm |
| Sensor length | 10 mm |
| Sensor width | 25 mm |
| Wire cross section | 0.25 mm ² |

ELECTRICAL FEATURES

| | |
|----------------------------------|-----------------------|
| Cascadable | - |
| Hysteresis | 15 % |
| No-load current | 13 mA |
| Norm measuring plate | 18x18x1 |
| Operating voltage | 10 V ... 30 V |
| Rated switching current | 200 mA |
| Residual ripple | 10 % |
| Suitable for safety functions | - |
| Supply voltage | 10 V ... 30 V |
| Switching behavior of the output | Static |
| Switching distance | 5 mm |
| Switching frequency | 1000 Hz |
| Type of electrical connection | Cable |
| Type of switching function | Normally open contact |
| Type of switching output | PNP |
| Voltage drop | 2.4 V |

ELECTRICAL FEATURES

| | |
|--|----|
| Voltage type | DC |
| With LED display | + |
| With monitoring function of downstream devices | - |

Other

| | |
|----------------------|---------------------------|
| Packaging dimensions | 77.0mm x 25.0mm x 123.0mm |
| Shipping weight | 0.09kg |
| Tariff code | 85365019 |

Classification

| | |
|-------------------|----------|
| ipf product group | 215 |
| eClass 8.0 | 27270101 |
| eClass 9.0 | 27270101 |
| eClass 9.1 | 27270101 |
| ETIM-5.0 | EC002714 |
| ETIM-6.0 | EC002714 |
| ETIM-7.0 | EC002714 |

Connection

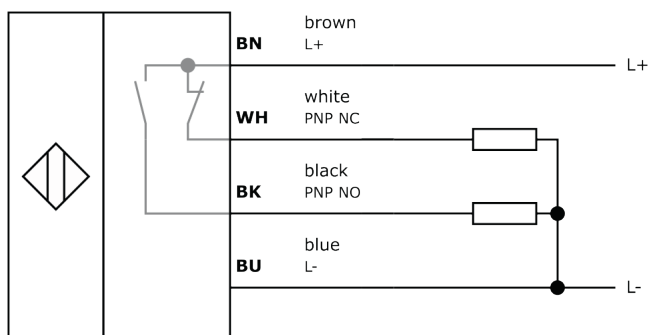

Dimensional drawing

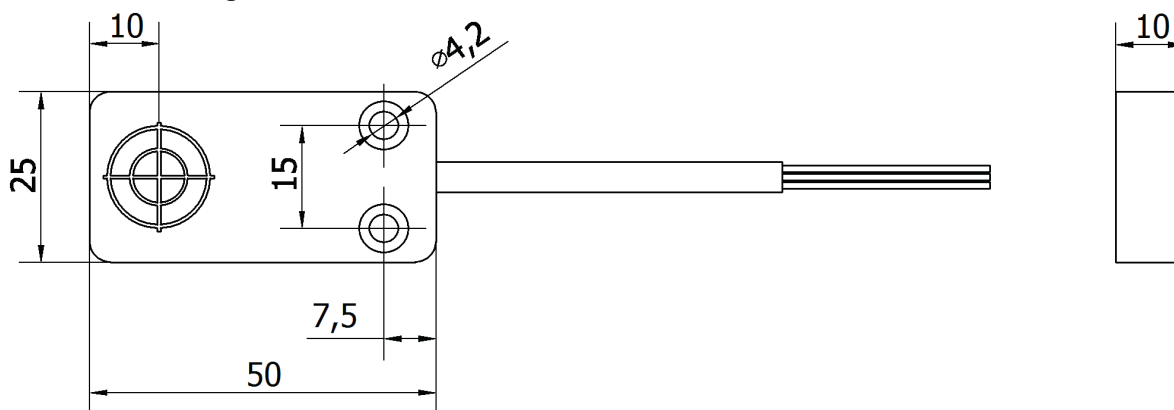

Installation



Mounting / installation may only be carried out by a qualified electrician!

Disposal



Safety warnings

Before initial operation, please make sure to follow all safety instructions that may be provided in the product information.

Never use these devices in applications where the safety of a person depends on their functionality.

LED lighting systems can generate intensive UV radiation, which can damage your eyes in case of improper use. The manufacturer cannot be held responsible for damages that result from improper use or connection.