

IB08A014
INDUCTIVE SENSORS • NORM SWITCHING DISTANCE

sensor inductive, M8x1 30long, Flush, Sn: 2, 12-30V DC, 100°C, PNP
NO, Cable connector M8 0.21m Polytetrafluorethylene (PTFE), IP67,
Stainless steel

MECHANICAL FEATURES

| | |
|--|-------------------------------|
| Alignment of cable entry | Axial |
| Ambient temperature | -25 °C ... 100 °C |
| Cable infeed | Axial |
| Cable length | 0.21 m |
| Degree of protection (IP) | IP67 |
| Design | Cylinder, screw-thread |
| Housing material | Stainless steel |
| Increased ambient temperatures > 80°C | + |
| Material of cable sheath | Polytetrafluorethylene (PTFE) |
| Mechanical mounting condition for sensor | Flush |
| Pressure-proof | - |
| Sensor length | 30 mm |
| Thread pitch | 1 mm |
| Thread size, metric | 8 |

ELECTRICAL FEATURES

| | |
|-------------------------------|-----------------------|
| Cascadable | - |
| Hysteresis | 20 % |
| No-load current | 12 mA |
| Norm measuring plate | 8x8x1 |
| Rated switching current | 50 mA |
| Reverse polarity protection | + |
| Short-circuit protection | + |
| Suitable for safety functions | - |
| Supply voltage | 12 V ... 30 V |
| Switching distance | 2 mm |
| Switching frequency | 5000 Hz |
| Type of electrical connection | Cable connector M8 |
| Type of switching function | Normally open contact |
| Type of switching output | PNP |
| Voltage drop | 3 V |
| Voltage type | DC |
| With LED display | + |

ELECTRICAL FEATURES

With monitoring function of downstream devices

-

Other

| | |
|----------------------|-----------------------|
| Packaging dimensions | 100mm x 0.0mm x 120mm |
| Shipping weight | 0.02kg |
| Tariff code | 85365019 |

Classification

| | |
|-------------------|----------|
| ipf product group | 700 |
| eClass 8.0 | 27270101 |
| eClass 9.0 | 27270101 |
| eClass 9.1 | 27270101 |
| ETIM-5.0 | EC002714 |
| ETIM-6.0 | EC002714 |
| ETIM-7.0 | EC002714 |

Connection

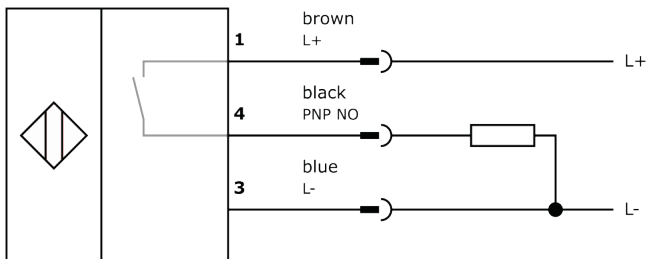

Dimensional drawing

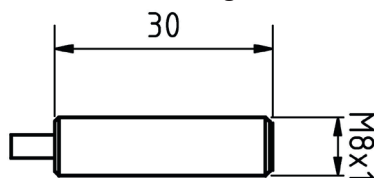

Installation



Mounting / installation may only be carried out by a qualified electrician!

Disposal



Safety warnings

Before initial operation, please make sure to follow all safety instructions that may be provided in the product information. Never use these devices in applications where the safety of a person depends on their functionality. LED lighting systems can generate intensive UV radiation, which can damage your eyes in case of improper use. The manufacturer cannot be held responsible for damages that result from improper use or connection.

