

IB050106**INDUCTIVE SENSORS • INCREASED SWITCHING DISTANCE**

sensor inductive, M5x0.5 25long, Flush, Sn: 1.5, 10-30V DC, PNP NO,
IO-Link, Cable 5m PUR (Polyurethane), IP67, V4A

**MECHANICAL FEATURES**

Active area material of sensor	PA 6.6 (synthetic)
Alignment of cable entry	Axial
Ambient temperature	-25 °C ... 70 °C
Cable infeed	Axial
Cable length	5 m
Degree of protection (IP)	IP67
Design	Cylinder, screw-thread
Housing material	Stainless steel 1.4404
Material of cable sheath	PUR (Polyurethane)
Max. tightening torque	1.5 Nm
Mechanical mounting condition for sensor	Flush
Number of cores	3
Pressure-proof	-
Sensor length	25 mm
Thread length	20 mm
Thread pitch	0.5 mm
Thread size, metric	5

ELECTRICAL FEATURES

Cascadable	-
Correction factor (aluminum)	0.4
Correction factor (brass)	0.5
Correction factor (copper)	0.4
Correction factor (St37)	1
Correction factor (stainl. steel)	0.75
Hysteresis	10 %
IO-Link compatible	+
No-load current	10 mA
Norm measuring plate	5x5x1
Rated switching current	200 mA
Relative repeat accuracy	2 %
Reverse polarity protection	+
Short-circuit protection	+

ELECTRICAL FEATURES

Suitable for safety functions	-
Supply voltage	10 V ... 30 V
Switching distance	1.5 mm
Switching frequency	3000 Hz
Type of electrical connection	Cable
Type of switching function	Normally open contact
Type of switching output	PNP
Voltage drop	2 V
Voltage type	DC
With LED display	+
With monitoring function of downstream devices	-

Other

Packaging dimensions	77.0mm x 25.0mm x 123.0mm
Shipping weight	0.08kg
Tariff code	85365019

Classification

ipf product group	201
eClass 8.0	27270101
eClass 9.0	27270101
eClass 9.1	27270101
ETIM-5.0	EC002714
ETIM-6.0	EC002714
ETIM-7.0	EC002714

Connection

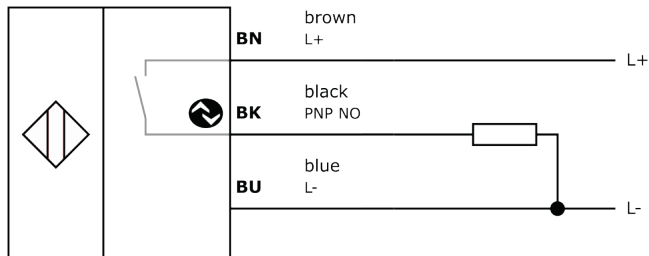

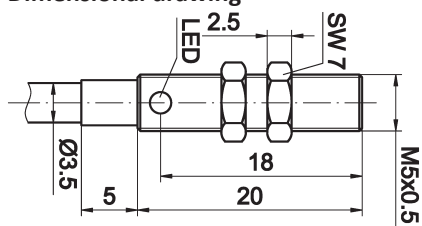
Dimensional drawing**Installation**

Mounting / installation may only be carried out by a qualified electrician!

Disposal**Software**

Any software, drivers or IODD files that may be required to operate your device can be downloaded free of charge from our homepage: www.ipf-electronic.com

Safety warnings

Before initial operation, please make sure to follow all safety instructions that may be provided in the product information.

Never use these devices in applications where the safety of a person depends on their functionality.

LED lighting systems can generate intensive UV radiation, which can damage your eyes in case of improper use. The manufacturer cannot be held responsible for damages that result from improper use or connection.