

C44U_M, Film, Metallized Polypropylene, DC Link, 2100 uF, 10%, 600 VDC

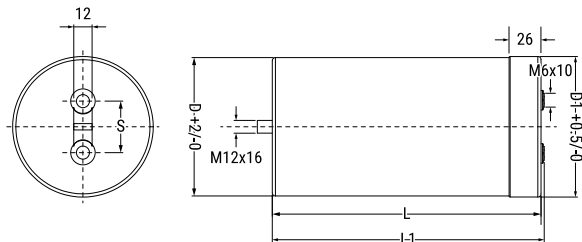

General Information

Series:	C44U_M
Dielectric:	Metallized Polypropylene
Style:	Can
Features:	DC Filtering, Energy Storage
RoHS:	Yes
Lead:	Screw Terminals M6
AEC-Q200:	No
Miscellaneous:	Thermal Resistance = 2.6 C/W. Weight = 9200 grams.

Dimensions

D	85mm +2mm
L	268.5mm +/-2mm
L1	270mm +/-2mm
S	32mm +/-0.3mm

Packaging Specifications

Mounting:	Bolt - M12x16
Packaging:	Bulk, Bag
Packaging Quantity:	5

Specifications

Capacitance:	2100 uF
Capacitance Tolerance:	10%
Voltage DC:	600 VDC
Temperature Range:	-40/+85°C
Rated Temperature:	75°C
Insulation Resistance:	0.01 MOhms
Max dV/dt:	3 V/us
Resistance:	1.7 mOhms (10kHz)
Ripple Current:	82 Amps (10kHz 40C), 6900 Amps (Peak)
Inductance:	80 nH