

JBC

www.jbctools.com



MV

PNEUMATIC SUCTION MODULE

MV / PNEUMATIC SUCTION MODULE

MV-A
PNEUMATIC SUCTION
MODULE



0010207
MODULE CABLE
CONNECTOR



MANUAL



0821830
FILTER SUCTION SET



0005966
50 FILTERS BOX



0781046
COTTON FILTERS



0008446
ESCAPE FILTER



INSTALLATION

MV-A
PNEUMATIC SUCTION
MODULE

DD-2B
CONTROL UNIT

Connectable control units:
DI, DD, DDR, DM.

Connectable Compact line:
CV

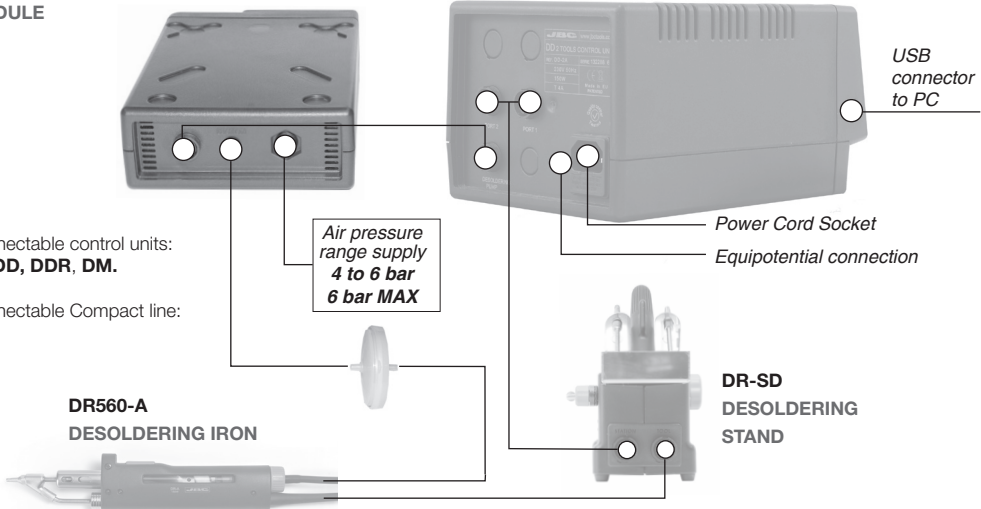

PNEUMATIC SUCTION MODULE ELEMENTS



CHANGING PUMP FILTERS

IMPORTANT!!!

Do not open the external filter with sharps in order to avoid damage

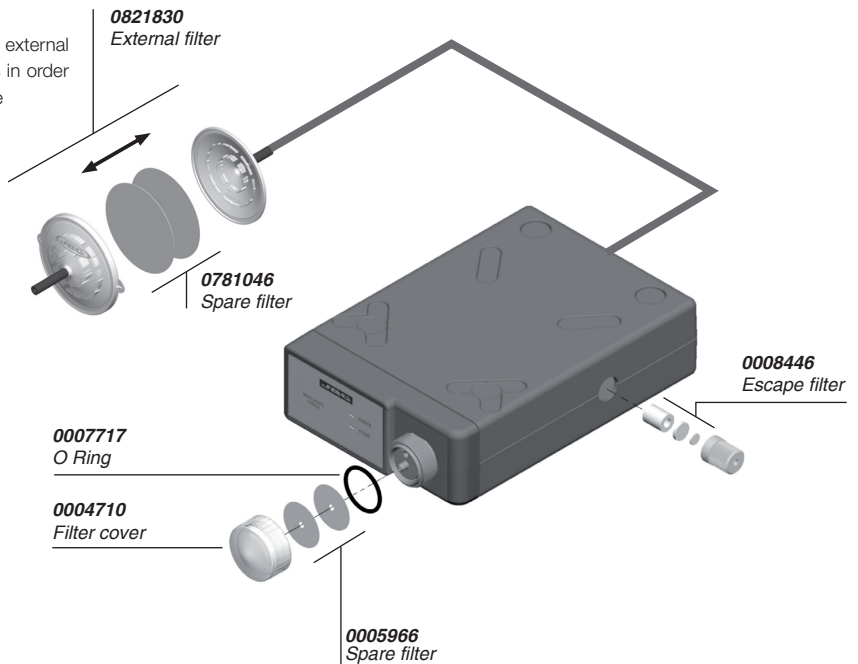

TECHNICAL SPECIFICATIONS

- Air pressure range supply: 4-6 bar
- Maximum Air pressure: 6 bar
- Weight of complete unit: 0,7 kg (1,6 lb)
- Complies with CE standards on electrical safety, electromagnetic compatibility and ESD protected housing "skin effect"
- RoHS compliant
- Equipotential connector and the tool tip are connected to station mains ground supply for ESD protection



This product should not be thrown in the garbage.

JBC

WARRANTY

JBC's 2 years warranty guarantees this equipment against all manufacturing defects, covering the replacement of defective parts and all necessary labour.

Warranty does not cover product wear due to use or mis-use.

In order for the warranty to be valid, equipment must be returned, postage paid, to the dealer where it was purchased enclosing this fully filled in, sheet.

SERIAL N°

STAMP OF DEALER

DATE OF PURCHASE

www.jbctools.com

0008797-1013