

U.I. Lapp GmbH	DATASHEET	
	EPIC KIT LS1 A1 6-POL MALE	75009691 29.11.2013

Circular connectors for servomotors and power supply
High power at smallest installation space, Optimal solution for electric motors
EMC-optimised
Safety use in field environment by high protection class



Good chemical resistance



Corrosion-resistant



Industrial machinery and plant engineering



Maximum vibration protection



Mechanical resistance



Assembly time



Space requirement



Robust



Waterproof



Wind Energy



Variety of approval certifications

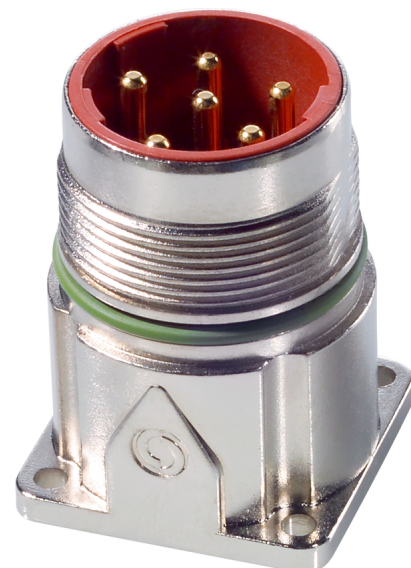

Application range

Plant engineering
Servo drives and servo assemblies

Remark

Photographs are not to scale and do not represent detailed images of the respective products.

Product Management	Document: EPIC KIT LS1 A1 6-POL MALE	1 / 3
--------------------	--------------------------------------	-------

U.I. Lapp GmbH	DATASHEET	 LAPP GROUP
	EPIC KIT LS1 A1 6-POL MALE	75009691 29.11.2013

Technical Data

Article number:	75009691
Rated voltage (V):	630 V (2 mm contacts) 250 V (1 mm contacts)
Rated impulse voltage:	6 kV (2 mm contacts) 4 kV (1 mm contacts)
Rated current (A):	26A/3+PE+4, 25A/5+PE (2mm contacts) 7 A (1 mm contacts)
Contact resistance:	< 4 mOhm
Contacts:	Gold-plated brass
Number of contacts:	3 + PE + 4 5 + PE
Termination methods:	Crimp termination: 0.5 - 2.5 mm ² (2 mm contacts) Crimp termination: 0.14 - 1.0 mm ² (1 mm contacts)
Material:	Housing: nickel-plated zinc die-casting, nickel-plated brass Insert: PA, Seal: FPM
Protection rating:	IP68 (10h / 1m)
Cycle of mechanical operation:	500
Temperature range:	-25°C až +125°C
VDE-tested:	Certified production control: VDE-REG. no. B25
Degree of soiling:	3

Product Management	Document: EPIC KIT LS1 A1 6-POL MALE	2 / 3
--------------------	--------------------------------------	-------

U.I. Lapp GmbH	DATASHEET	 LAPP GROUP
	EPIC KIT LS1 A1 6-POL MALE	75009691 29.11.2013

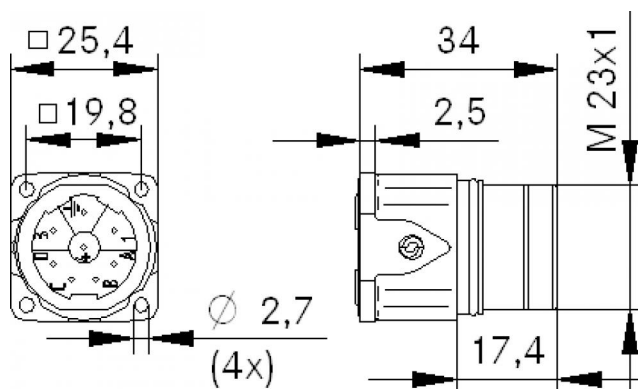

Product Management	Document: EPIC KIT LS1 A1 6-POL MALE	3 / 3
--------------------	--------------------------------------	-------