

## „DESIGN” Surface-mounted socket 16A 3P 250V IP44

Cat. No. **863108V**



- with screw terminals
- housing material: PC/ABS
- contacts: nickel-plated contacts
- with pin
- Flange can be rotated by 180° - straight and sloping design all in one!
- one side entry with offset nipple, possible entry on the other with cutout
- with inscription field

Connection  
to the future

**IP44 splashproof**

### DIMENSIONS:

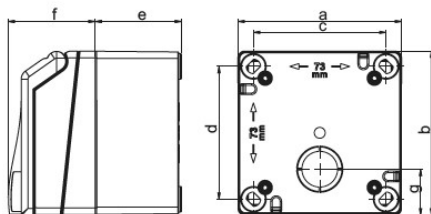

**PCE Polska Sp. z o. o.**

ul. Podwalna 8A  
58-200 Dzierżoniów  
TEL. +48 74 831 76 00  
MAIL: [pce@pce.pl](mailto:pce@pce.pl)  
[www.pce.pl](http://www.pce.pl)