

CAB547RF: HIROSE U.FL PLUG + SMA STRAIGHT BULKHEAD JACK WITH O-RING RATED TO IP67/68 +  $\phi 1.13\text{MM}$  CABLE, 6GHz

SPECIFICATIONS :

1. HIROSE U.FL PLUG, P/N: U.FL-LP-068.
2.  $\phi 1.13\text{MM}$  COAXIAL CABLE, COLOR: GRAY.
3. SMA STRAIGHT BULKHEAD JACK WITH O-RING RATED TO IP67/68,  
P/N: RFCT-SMA069-F78.

## ENVIRONMENTAL:

- A. BULKHEAD MOUNTED CONNECTOR (RFCT-SMA069-F78) RATED TO THE FOLLOWING SPECIFICATION:
- i. IP6X – DUST TIGHT – NO PARTICLE INGRESS.
  - ii. IPX7 WATERPROOF FOR 30 MINUTES UP TO 1 METER UNDERWATER.
  - iii. IPX8 WATERPROOF FOR 48 HOURS AT 1 METER UNDERWATER.

NOTES:

1. THE ORIENTATION OF CONNECTORS ON DRAWING IS FOR REFERENCE ONLY, IF THE ORDER IS LEFT BLANK THE CONNECTOR WILL NOT HAVE FIXED ORIENTATION.
2. FIXED ORIENTATION IS SUGGESTED FOR CABLE LENGTH 50MM TO 100MM. PLEASE SPECIFY THE FIXED ORIENTATIONS FROM THE ORDER CODE (F1, F2, ETC)
3. CONTACT GCT IF THE ORIENTATION YOU REQUIRE IS NOT SHOWN.
4. WORKING FREQUENCY RANGE: DC-6GHz.
5. OPERATING TEMPERATURE: -40°C~+85°C.
6. IMPEDANCE: 50 Ohm.

USAGE PRECAUTIONS: CABLES USING 'MICRO' COAX ARE DELICATE:

- (i) HANDLE WITH CARE.
- (ii) DO NOT TWIST; APPLY EXCESSIVE FORCES OR SHARP BENDS TO THE CABLE. DO NOT FORCEFULLY DEFORM WIRES.
- (iii) CONSULT CONNECTOR MANUFACTURER'S DATASHEETS FOR DETAILED NOTES ON HANDLING INSTRUCTIONS.

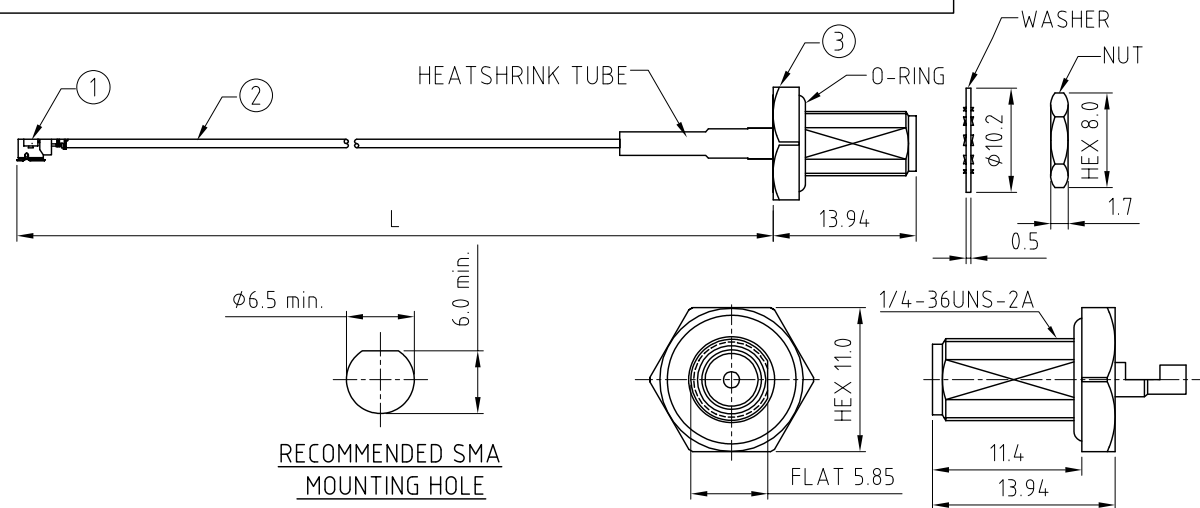

## HOW TO ORDER

CAB547RF - X X X X - X X - X - 1

"L" LENGTH IN MM:  
eg: 100MM = 0100  
(MIN. 0050-MAX.0400  
STANDARD = 0100, 0150, 0200)  
Tolerance: 50-200mm:  $\pm 5\text{mm}$ .  
201-400mm:  $\pm 7\text{mm}$ .

CABLE SIZE:  
1 = Ø1.13MM CABLE, COLOR: GREY

WASHER AND NUT OPTIONS:  
BLANK = SEPARATELY PACKED (STANDARD)  
A = ASSEMBLED WITH CONNECTOR

ORIENTATION OPTIONS:

BLANK = DOES NOT HAVE A FIXED ORIENTATION  
F1 = U.FL CONNECTION DOWN (L=50-200MM)  
F2 = U.FL CONNECTION UP (L=50-200MM)  
F3 = U.FL CONNECTION AND D FLAT SAME ORIENTATION (L=50-200MM)  
F4 = U.FL CONNECTION AND D FLAT OPPOSITE ORIENTATION (L=50-200MM)  
(SEE NOTES 1, 2, 3 AND DIAGRAMS FOR MORE INFORMATION)

SMA DETAIL DRAWING

