

CABLE 348 RF: RF CABLE ASSEMBLY, I-PEX MHF + SMA BULKHEAD JACK + MULTIPLE CABLE SIZES - 6GHz

SPECIFICATIONS:

1. I-PEX MHF PLUG, P/N: FOR RG178 CABLE:20278-112R-18,
FOR Ø1.13MM & Ø1.13MM LOW LOSS CABLE: 20278-112R-13
2. COAXIAL CABLE, SEE P/N OPTION FOR DETAIL.
3. SMA STRAIGHT BULKHEAD JACK, GOLD PLATED, P/N:
FOR RG178 CABLE: RFCT-SMA139-F78.
FOR Ø1.13MM&Ø1.13MM LOW LOSS CABLE:
RFCT-SMA059-F13.

USAGE PRECAUTIONS: CABLES USING 'MICRO' COAX ARE DELICATE:

(i) HANDLE WITH CARE.

(ii) DO NOT TWIST; APPLY EXCESSIVE FORCES OR SHARP BENDS TO THE CABLE. DO NOT FORCEFULLY DEFORM WIRES.

(iii) CONSULT CONNECTOR MANUFACTURER'S DATASHEETS FOR DETAILED NOTES ON HANDLING INSTRUCTIONS.

NOTES:

1. THE ORIENTATION OF CONNECTORS ON DRAWING IS FOR REFERENCE ONLY, IF THE ORDER IS LEFT BLANK THE CONNECTOR WILL NOT HAVE FIXED ORIENTATION.
2. FIXED ORIENTATION IS SUGGESTED FOR CABLE LENGTH 25MM TO 100MM. PLEASE SPECIFY THE FIXED ORIENTATIONS FROM THE ORDER CODE (F1, F2, ETC)
3. CONTACT GCT IF THE ORIENTATION YOU REQUIRE IS NOT SHOWN.
4. WORKING FREQUENCY RANGE: DC-6GHz
5. OPERATING TEMPERATURE: -40°C TO +85°C
6. IMPEDANCE: 50 OHM
7. VSWR: 1.5 MAX.

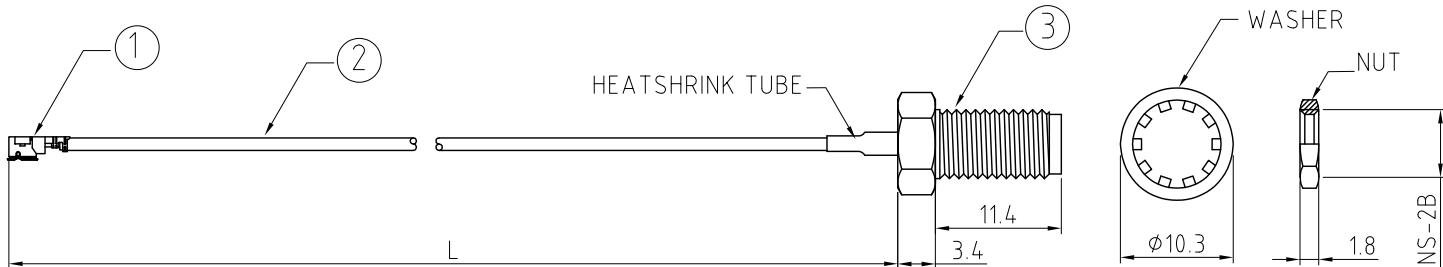

HOW TO ORDER

CABLE 348 RF - X X X - X X - X - X

"L" LENGTH IN MM
eg: 100MM = 100
(MIN. 025-MAX.400)
STANDARD = 100, 150, 200)
Tolerance: <50mm : ±3mm.
51-200mm: ±5mm.
201-400mm: ±7mm.

CABLE SIZE OPTIONS:

1 = Ø1.13MM CABLE, COLOR: GRAY.

2 = RG178 CABLE, COLOR: BROWN.

3 = Ø1.13MM LOW LOSS CABLE, COLOR: GRAY.

4 = Ø1.13MM CABLE, COLOR: BLACK.

WASHER AND NUT OPTIONS:
BLANK = SEPARATELY PACKED (STANDARD)
A = ASSEMBLED WITH CONNECTOR
C = ACCESSORIES NOT SUPPLIED

ORIENTATION OPTIONS:
BLANK = DOES NOT HAVE A FIXED ORIENTATION
F1 = MHF CONNECTION DOWN (L=25-200MM)
F2 = MHF CONNECTION UP (L=25-200MM)
F3 = MHF CONNECTION AND D FLAT SAME ORIENTATION (L=25-200MM)
F4 = MHF CONNECTION AND D FLAT OPPOSITE ORIENTATION (L=25-200MM)
(SEE NOTES 1, 2, 3 AND DIAGRAMS FOR MORE INFORMATION)

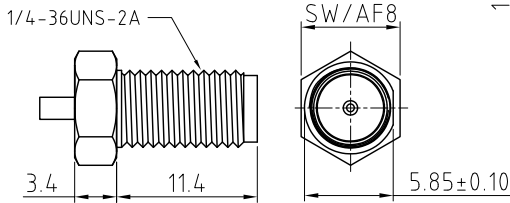

SMA JACK DETAIL DIMENSION

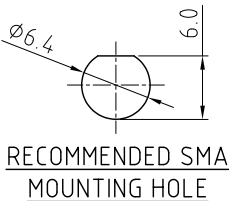

RECOMMENDED SMA MOUNTING HOLE

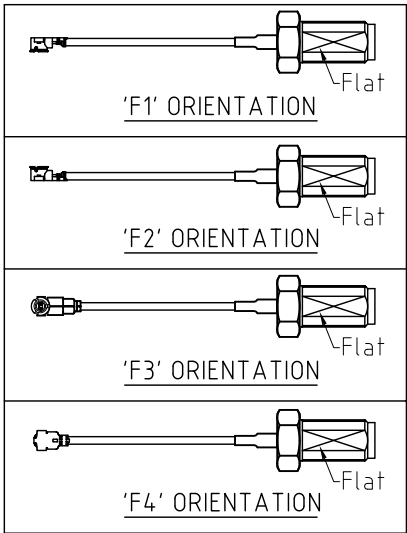

REV.	DATE & DRN	DESCRIPTION
10	03/07/19	- NYW RELEASE
11	06/07/20	- NYW
12	06/07/20	- NYW
13	06/07/20	- NYW
14	06/07/20	- NYW
15	06/07/20	- NYW
16	06/07/20	- NYW
17	06/07/20	- NYW
18	06/07/20	- NYW
19	06/07/20	- NYW
20	06/07/20	- NYW
21	06/07/20	- NYW
22	06/07/20	- NYW

Scale:	NTS	THIRD ANGLE	Unstated .X .XX	Tolerances: ±0.5 ±0.2	Material SEE NOTE
Drawn:	CC		ANGLES	±5	
App'd:	XXX	Title	CABLE ASSEMBLY	NOT TO SCALE	
Date:	22 Feb. '25	Revision:	2.0	Unit:	mm



Type:	Cable 348 RF
CABLE 348 RF	
Drawing Number:	
Sheet 1	of 1
Drawing ©	E and O E