

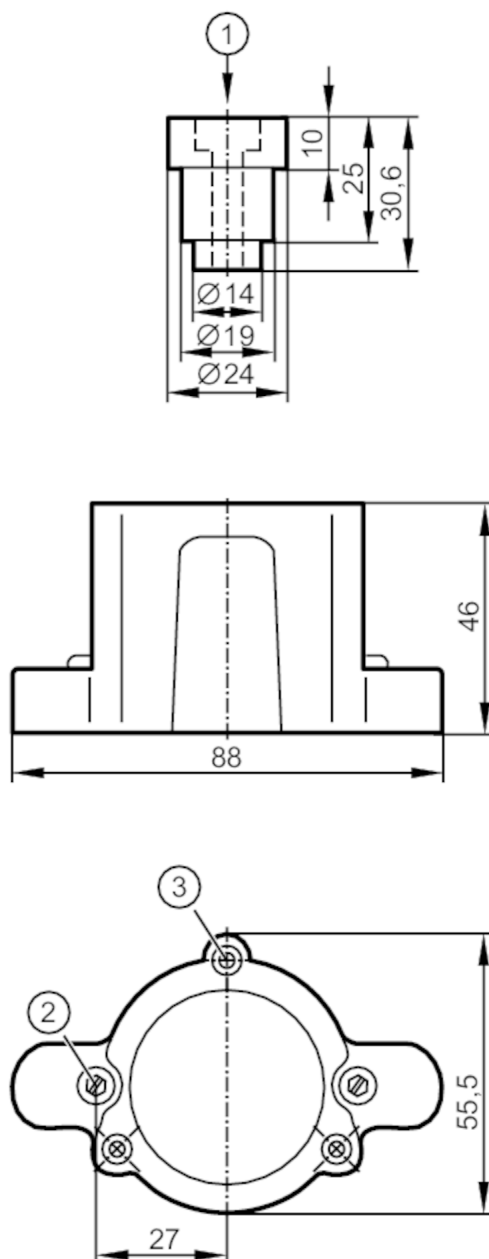

Mounting adapter for position sensors used on rising stem valves

ADAPTER VALVIS_04



- 1 socket head screw to fix the target on the valve piston
 2 head cap screw M4 to fix the adapter on the valve
 3 threaded hole M4 to fix the valve sensor on the adapter

Application

Design accessories for IX5010, IX5030, for valves Alfa Laval Typ SSV (Single Seat Valves)

Mechanical data

Weight [g] 160

Materials Adapter: PA; Target: stainless steel (316L/1.4404)

Accessories

Items supplied socket head screw: 1 x M4
 socket head screws: 1 x M6
 Mounting plate

Remarks

Pack quantity 1 pcs.