

Pushbutton Ø 22 mm silver contact

82-6562.1000



<https://eao.com/p/82-6562.1000>

Your product:



82-6562.1000
Pushbutton Ø 22 mm silver contact

FRONT

Front bezel material:	Aluminium
Front bezel shape:	flush

MOUNTING

Mounting cut-out:	Ø 22 mm
-------------------	---------

OPERATING-/INDICATION PART

Lens colour:	Nature
Lens optics:	opaque
Lens shape:	flush
Lens illumination:	non illuminative
Lens material:	Aluminium

ELECTRICAL CHARACTERISTICS

Thermal current Ith:	5 A
Electric strength:	1500 VAC, 50 Hz 1 minute between life terminals and ground

Switching voltage and switching current:	according to IEC 60947-5-1 (Silver contacts)	
	Service categorie AC-15	
	Voltage	Current
	24 VAC	1 A
	35 VAC	1 A (M12 versio
	110 VAC	1 A
	220 VAC	0.5 A
	Switch rating DC service categorie DC-13 (Silver contacts)	
	Voltage	Current
	24 VDC	0.7 A
	35 VDC	0.5 A (M12 vers
	110 VDC	0.2 A
	220 VDC	0.1 A

according to UL 508 (Silver contacts)

cos ϕ 0,75 ... 0,8

Voltage

120 VAC

240 VAC

24 VAC

Current

5 A

3 A

1 A

Pollution degree: 2, according to EN IEC 60947-1

Rated insulation voltage U_i : 250 V

Contacts: 1 C

Electrical lifetime: 50 000 cycles of operation

Rated Operational Voltage U_e : 250 VAC

MECHANICAL CHARACTERISTIC

Switching system: Snap-action switching element

Operating force: 4 N ... 7 N

Terminal: Screw terminal

Contact material: Silver

Mechanical lifetime: 1 Mio. cycles of operation

Tightening torque: 0.5 ... 0.6 Nm, Screw terminal 0.1 Nm

Weight: 0.02 kg

Operating Travel: ca. 3 mm

Switching action: Momentary

AMBIENT CONDITION

Storage temperature: – 40 °C ... + 80 °C

Operating temperature: – 30 °C ... + 70 °C

Climate resistance: Damp heat, 21 days according to IEC 60512-11

Shock resistance: Max. 500 m / s² as per IEC 60068-2-27

Vibration resistance: 10 ... 500 Hz, amplitude 1.5 mm p-p according to IEC 60068-2-6

CERTIFICATE

Conformities: CE, 2011 / 65 / EC (RoHS), 2014 / 35 / EU (LVD)

Approbations: CB, CCC, C UL, UL

OTHER

Short Description:

Pushbutton Ø 22 mm silver contact, Momentary, 1 C, Screw terminal, Aluminium, Nature

Dimension drawings:

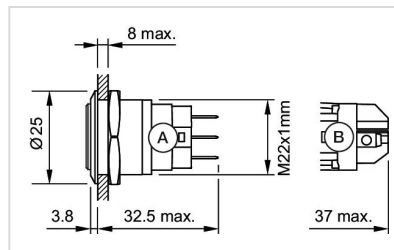

A = Solder terminal
B = Screw terminal

Mounting cut-outs:

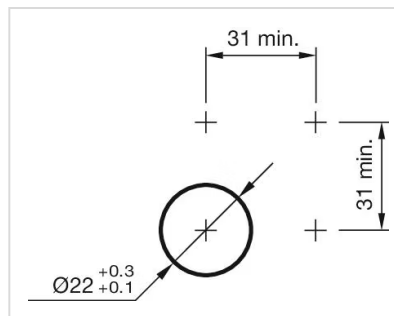

Component layouts:

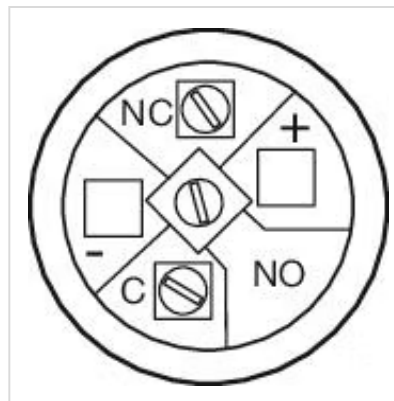

Wiring diagrams:

