

## Pushbutton Ø 22 mm silver contact

82-6172.2000



<https://eao.com/p/82-6172.2000>

Your product:



82-6172.2000  
Pushbutton Ø 22 mm silver contact

FRONT

Front bezel shape:	flush
Front bezel material:	Stainless steel

MOUNTING

Mounting cut-out:	Ø 22 mm
-------------------	---------

OPERATING-/INDICATION PART

Lens shape:	convex
Lens illumination:	non illuminative
Lens optics:	opaque
Lens material:	Stainless steel
Lens colour:	Silver

ELECTRICAL CHARACTERISTICS

Switching voltage and switching current:	according to IEC 60947-5-1 (Silver contacts)	
	Service categorie AC-15	
	Voltage	Current
	24 VAC	1 A
	35 VAC	1 A (M12 versio
	110 VAC	1 A
	220 VAC	0.5 A
	Switch rating DC service categorie DC-13 (Silver contacts)	
	Voltage	Current
	24 VDC	0.7 A
	35 VDC	0.5 A (M12 vers
	110 VDC	0.2 A
	220 VDC	0.1 A

according to UL 508 (Silver contacts)

$\cos\phi$  0,75 ... 0,8

Voltage

120 VAC

240 VAC

24 VAC

Current

5 A

3 A

1 A

<b>Pollution degree:</b>	2, according to EN IEC 60947-1
<b>Rated Operational Voltage <math>U_e</math>:</b>	250 VAC
<b>Thermal current <math>I_{th}</math>:</b>	5 A
<b>Rated insulation voltage <math>U_i</math>:</b>	250 V
<b>Electric strength:</b>	1500 VAC, 50 Hz 1 minute between life terminals and ground
<b>Electrical lifetime:</b>	50 000 cycles of operation
<b>Contacts:</b>	1 C

## MECHANICAL CHARACTERISTIC

<b>Switching system:</b>	Snap-action switching element
<b>Switching action:</b>	Maintained
<b>Tightening torque:</b>	0.5 ... 0.6 Nm, Screw terminal 0.1 Nm
<b>Operating Travel:</b>	ca. 3 mm
<b>Contact material:</b>	Silver
<b>Terminal:</b>	Screw terminal
<b>Operating force:</b>	4 N ... 7 N
<b>Weight:</b>	0.019 kg
<b>Mechanical lifetime:</b>	500 000 cycles of operation

## AMBIENT CONDITION

<b>Storage temperature:</b>	- 40 °C ... + 80 °C
<b>Vibration resistance:</b>	10 ... 500 Hz, amplitude 1.5 mm p-p according to IEC 60068-2-6
<b>Climate resistance:</b>	Damp heat, 21 days according to IEC 60512-11
<b>Operating temperature:</b>	- 30 °C ... + 70 °C
<b>Shock resistance:</b>	Max. 500 m / s <sup>2</sup> as per IEC 60068-2-27

## CERTIFICATE

**Conformities:**

CE, 2011 / 65 / EC (RoHS), 2014 / 35 / EU (LVD)

**Approbations:**

CB, CCC, C UL, UL

**OTHER****Short Description:**

Pushbutton Ø 22 mm silver contact, Maintained, 1 C, Screw terminal, Stainless steel, Silver

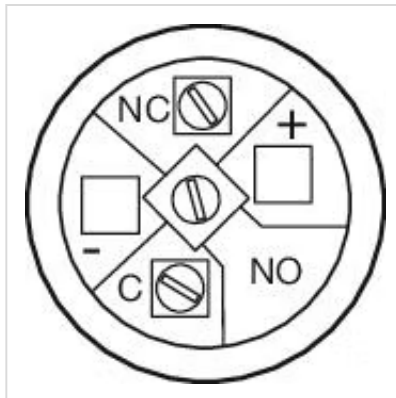
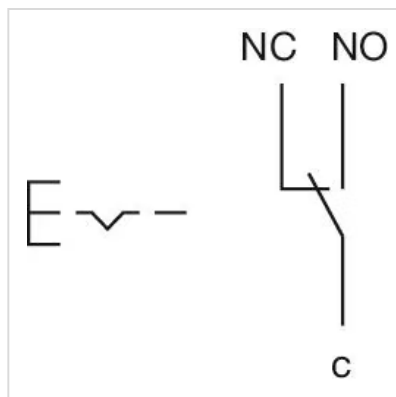
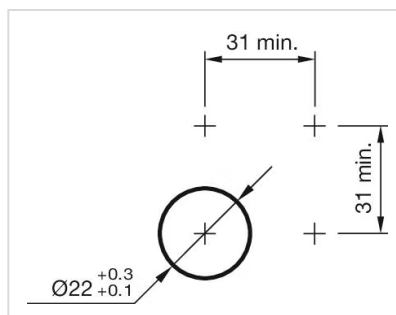
**Component layouts:****Wiring diagrams:****Mounting cut-outs:****Dimension drawings:**

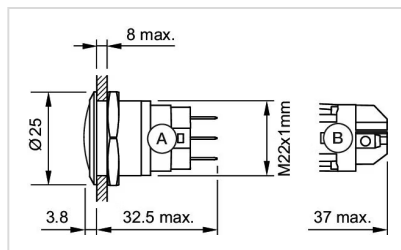

A = Solder terminal  
B = Screw terminal