

## Illuminated pushbutton Ø 22 mm silver contact

82-6152.2113.B001



<https://eao.com/p/82-6152.2113.B001>

Your product:

---



82-6152.2113.B001  
Illuminated pushbutton Ø  
22 mm silver contact

#### FRONT

Front bezel shape:	flush
Front bezel material:	Stainless steel

#### MOUNTING

Mounting cut-out:	Ø 22 mm
-------------------	---------

#### OPERATING-/INDICATION PART

Lens shape:	flush
Lens illumination:	illuminative
Lens material:	Stainless steel
Lens optics:	opaque
Illumination colour:	Red
Lens colour:	Silver
Shape of illumination:	Ring

#### ELECTRICAL CHARACTERISTICS

Pollution degree:	2, according to EN IEC 60947-1
Rated Operational Voltage U <sub>e</sub> :	250 VAC
Switching voltage and switching current:	

according to IEC 60947-5-1 (Silver contacts)

Service categorie AC-15

Voltage

24 VAC

35 VAC

110 VAC

220 VAC

Current

1 A

1 A (M12 version)

1 A

0.5 A

Switch rating DC service categorie DC-13 (Silver contacts)

Voltage

24 VDC

35 VDC

110 VDC

220 VDC

Current

0.7 A

0.5 A (M12 version)

0.2 A

0.1 A

according to UL 508 (Silver contacts)

$\cos\phi$  0,75 ... 0,8

Voltage

120 VAC

240 VAC

24 VAC

Current

5 A

3 A

1 A

**Electric strength:** 1500 VAC, 50 Hz 1 minute between life terminals and ground

**Operating voltage:** 12 V AC/DC

**Thermal current I<sub>th</sub>:** 5 A

**Contacts:** 1 C

**Electrical lifetime:** 50 000 cycles of operation

**Rated insulation voltage U<sub>i</sub>:** 250 V

## MECHANICAL CHARACTERISTIC

**Weight:** 0.018 kg

**Switching system:** Snap-action switching element

**Operating force:** 4 N ... 7 N

**Tightening torque:** 0.5 ... 0.6 Nm, Screw terminal 0.1 Nm

**Mechanical lifetime:** 500 000 cycles of operation

**Contact material:** Silver

**Switching action:** Maintained

**Terminal:** Screw terminal

**Operating Travel:** ca. 3 mm

## AMBIENT CONDITION

**Storage temperature:** - 40 °C ... + 80 °C

**Climate resistance:** Damp heat, 21 days according to IEC 60512-11

**Vibration resistance:**

10 ... 500 Hz, amplitude 1.5 mm p-p according to IEC 60068-2-6

**Operating temperature:** - 30 °C ... + 70 °C

**Shock resistance:** Max. 500 m / s<sup>2</sup> as per IEC 60068-2-27

## CERTIFICATE

**Approbations:** CB, CCC, C UL, UL

**Conformities:** CE, 2011 / 65 / EC (RoHS), 2014 / 35 / EU (LVD)

## OTHER

**Short Description:** Illuminated pushbutton Ø 22 mm silver contact, Maintained, 12 V AC/DC, 1 C, Screw terminal, Stainless steel, Red, ON/OFF, Silver

**Symbol:** ON/OFF

**Kind of illumination:** Single-LED

**Component layouts:**

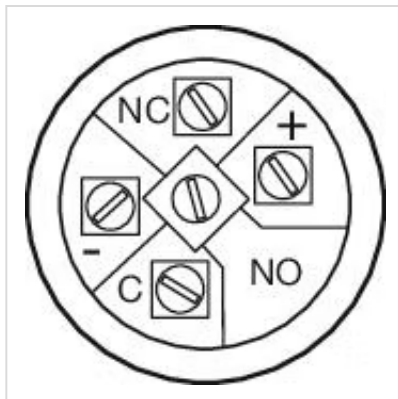

**Dimension drawings:**

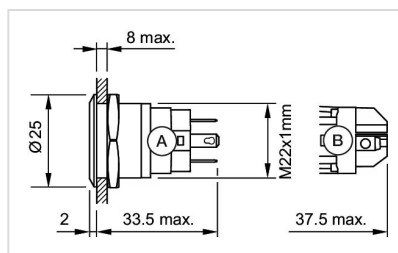

A = Solder terminal  
B = Screw terminal

**Mounting cut-outs:**

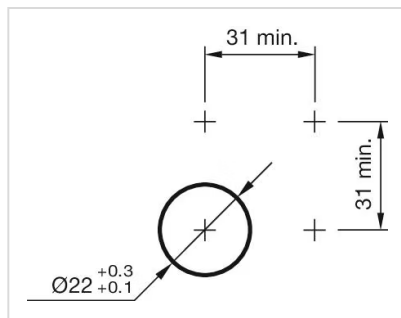

**Wiring diagrams:**

