

Illuminated pushbutton Ø 22 mm silver contact

82-6152.2114



<https://eao.com/p/82-6152.2114>

Your product:



82-6152.2114

Illuminated pushbutton Ø
22 mm silver contact

FRONT

Front bezel material: Stainless steel

Front bezel shape: flush

MOUNTING

Mounting cut-out: Ø 22 mm

OPERATING-/INDICATION PART

Lens illumination: illuminative

Lens shape: flush

Lens material: Stainless steel

Shape of illumination: Ring

Lens optics: opaque

Lens colour: Silver

Illumination colour: Red

ELECTRICAL CHARACTERISTICS

Rated Operational Voltage U_e: 250 VAC

Contacts: 1 C

Electric strength: 1500 VAC, 50 Hz 1 minute between life terminals and ground

Rated insulation voltage U_i: 250 V

Operating voltage: 24 V AC/DC

**Switching voltage and switching
current:**

according to IEC 60947-5-1 (Silver contacts)

Service categorie AC-15

Voltage

24 VAC

35 VAC

110 VAC

220 VAC

Current

1 A

1 A (M12 version)

1 A

0.5 A

Switch rating DC service categorie DC-13 (Silver contacts)

Voltage

24 VDC

35 VDC

110 VDC

220 VDC

Current

0.7 A

0.5 A (M12 version)

0.2 A

0.1 A

according to UL 508 (Silver contacts)

$\cos\phi$ 0,75 ... 0,8

Voltage

120 VAC

240 VAC

24 VAC

Current

5 A

3 A

1 A

Electrical lifetime: 50 000 cycles of operation

Thermal current I_{th}: 5 A

Pollution degree: 2, according to EN IEC 60947-1

MECHANICAL CHARACTERISTIC

Operating Travel: ca. 3 mm

Switching system: Snap-action switching element

Operating force: 4 N ... 7 N

Terminal: Screw terminal

Switching action: Maintained

Mechanical lifetime: 500 000 cycles of operation

Contact material: Silver

Tightening torque: 0.5 ... 0.6 Nm, Screw terminal 0.1 Nm

Weight: 0.018 kg

AMBIENT CONDITION

Vibration resistance: 10 ... 500 Hz, amplitude 1.5 mm p-p according to IEC 60068-2-6

Climate resistance: Damp heat, 21 days according to IEC 60512-11

Shock resistance: Max. 500 m / s² as per IEC 60068-2-27

Storage temperature: – 40 °C ... + 80 °C

Operating temperature: – 30 °C ... + 70 °C

CERTIFICATE

Conformities:

CE, 2011 / 65 / EC (RoHS), 2014 / 35 / EU (LVD)

Approbations:

CB, CCC, C UL, UL

OTHER

Kind of illumination:

Single-LED

Short Description:

Illuminated pushbutton Ø 22 mm silver contact, Maintained, 24 V AC/DC, 1 C, Screw terminal, Stainless steel, Red, Silver

Wiring diagrams:

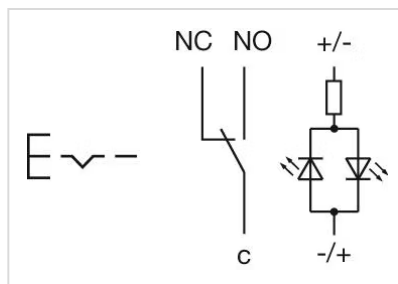

Component layouts:

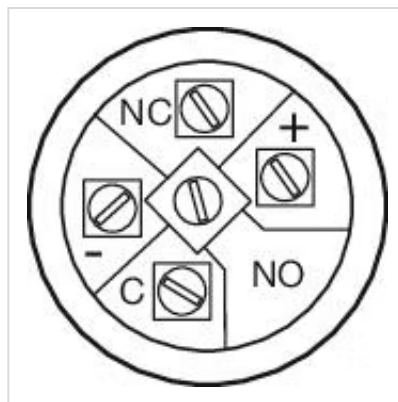

Mounting cut-outs:

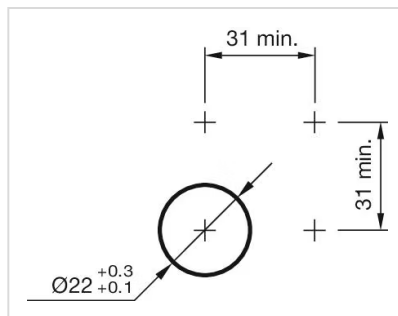

Dimension drawings:

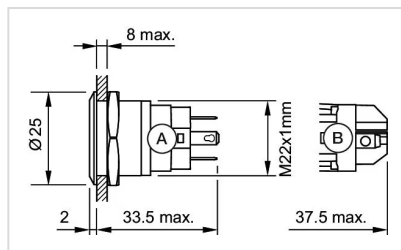

A = Solder terminal
B = Screw terminal