

Illuminated pushbutton Ø 19 mm silver contact

82-5552.2133



<https://eao.com/p/82-5552.2133>

Your product:



82-5552.2133

Illuminated pushbutton Ø
19 mm silver contact

FRONT

Front bezel material: Aluminium

Front bezel shape: flush

MOUNTING

Mounting cut-out: Ø 19 mm

OPERATING-/INDICATION PART

Lens shape: flush

Illumination colour: Green

Lens illumination: illuminative

Lens colour: Nature

Lens material: Aluminium

Lens optics: opaque

Shape of illumination: Ring

ELECTRICAL CHARACTERISTICS

Pollution degree: 2, according to EN IEC 60947-1

Contacts: 1 C

Operating voltage: 12 V AC/DC

Switching voltage and switching current:

according to IEC 60947-5-1 (Silver contacts)

Service categorie AC-15

Voltage

24 VAC

35 VAC

110 VAC

220 VAC

Current

1 A

1 A (M12 version)

1 A

0.5 A

Switch rating DC service categorie DC-13 (Silver contacts)

Voltage

24 VDC

35 VDC

110 VDC

220 VDC

Current

0.7 A

0.5 A (M12 version)

0.2 A

0.1 A

according to UL 508 (Silver contacts)

$\cos\phi$ 0,75 ... 0,8

Voltage

120 VAC

240 VAC

24 VAC

Current

5 A

3 A

1 A

Rated Operational Voltage U_e : 250 VAC

Electric strength: 1500 VAC, 50 Hz 1 minute between life terminals and ground

Electrical lifetime: 50 000 cycles of operation

Rated insulation voltage U_i : 250 V

Thermal current I_{th} : 5 A

MECHANICAL CHARACTERISTIC

Operating Travel: ca. 3 mm

Terminal: Screw terminal

Weight: 0.018 kg

Contact material: Silver

Switching action: Maintained

Mechanical lifetime: 500 000 cycles of operation

Tightening torque: 0.5 ... 0.6 Nm, Screw terminal 0.1 Nm

Operating force: 4 N ... 7 N

Switching system: Snap-action switching element

AMBIENT CONDITION

Climate resistance: Damp heat, 21 days according to IEC 60512-11

Vibration resistance: 10 ... 500 Hz, amplitude 1.5 mm p-p according to IEC 60068-2-6

Storage temperature: - 40 °C ... + 80 °C

Operating temperature:

– 30 °C ... + 70 °C

Shock resistance:

Max. 500 m / s² as per IEC 60068-2-27

CERTIFICATE

Approbations:

CB, CCC, C UL, UL

Conformities:

CE, 2011 / 65 / EC (RoHS), 2014 / 35 / EU (LVD)

OTHER

Kind of illumination:

Single-LED

Short Description:

Illuminated pushbutton Ø 19 mm silver contact, Maintained, 12 V AC/DC, 1 C,
Screw terminal, Aluminium, Green, Nature

Component layouts:

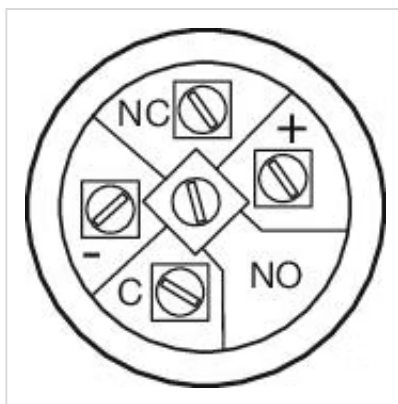

Wiring diagrams:

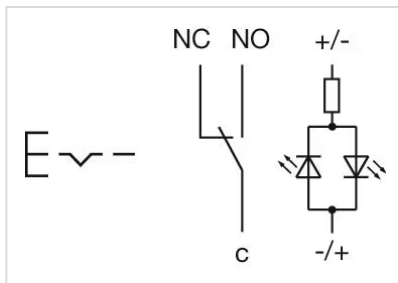

Mounting cut-outs:

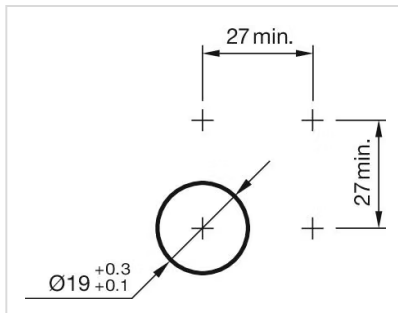

Dimension drawings:

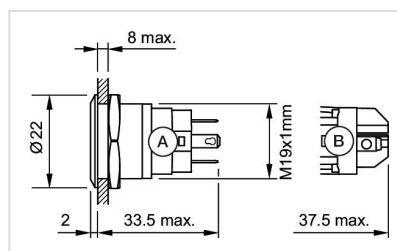

A = Solder terminal

B = Screw terminal