

Illuminated pushbutton Ø 19 mm silver contact

82-5552.2114



<https://eao.com/p/82-5552.2114>

Your product:



82-5552.2114

Illuminated pushbutton Ø
19 mm silver contact

FRONT

Front bezel shape:	flush
Front bezel material:	Aluminium

MOUNTING

Mounting cut-out:	Ø 19 mm
-------------------	---------

OPERATING-/INDICATION PART

Lens material:	Aluminium
Lens shape:	flush
Lens optics:	opaque
Lens colour:	Nature
Illumination colour:	Red
Lens illumination:	illuminative
Shape of illumination:	Ring

ELECTRICAL CHARACTERISTICS

Thermal current I _{th} :	5 A
Rated Operational Voltage U _e :	250 VAC
Electrical lifetime:	50 000 cycles of operation
Pollution degree:	2, according to EN IEC 60947-1
Operating voltage:	24 V DC
Switching voltage and switching current:	

according to IEC 60947-5-1 (Silver contacts)		
Service categorie AC-15		
Voltage		Current
24 VAC		1 A
35 VAC		1 A (M12 version)
110 VAC		1 A
220 VAC		0.5 A
Switch rating DC service categorie DC-13 (Silver contacts)		
Voltage		Current
24 VDC		0.7 A
35 VDC		0.5 A (M12 version)
110 VDC		0.2 A
220 VDC		0.1 A

according to UL 508 (Silver contacts)		
cosφ 0,75 ... 0,8		
Voltage		Current
120 VAC		5 A
240 VAC		3 A
24 VAC		1 A

Contacts:	1 C
Rated insulation voltage Ui:	250 V
Electric strength:	1500 VAC, 50 Hz 1 minute between life terminals and ground

MECHANICAL CHARATERISTIC

Weight:	0.018 kg
Switching system:	Snap-action switching element
Operating Travel:	ca. 3 mm
Contact material:	Silver
Terminal:	Screw terminal
Operating force:	4 N ... 7 N
Switching action:	Maintained
Tightening torque:	0.5 ... 0.6 Nm, Screw terminal 0.1 Nm
Mechanical lifetime:	500 000 cycles of operation

AMBIENT CONDITION

Shock resistance:	Max. 500 m / s ² as per IEC 60068-2-27
Vibration resistance:	10 ... 500 Hz, amplitude 1.5 mm p-p according to IEC 60068-2-6
Climate resistance:	Damp heat, 21 days according to IEC 60512-11
Operating temperature:	– 30 °C ... + 70 °C
Storage temperature:	– 40 °C ... + 80 °C

CERTIFICATE

Approbations:

CB, CCC, C UL, UL

Conformities:

CE, 2011 / 65 / EC (RoHS), 2014 / 35 / EU (LVD)

OTHER

Short Description:

Illuminated pushbutton Ø 19 mm silver contact, Maintained, 24 V DC, 1 C, Screw terminal, Aluminium, Red, Nature

Kind of illumination:

Single-LED

Wiring diagrams:

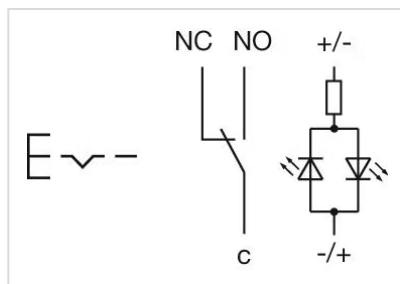

Dimension drawings:

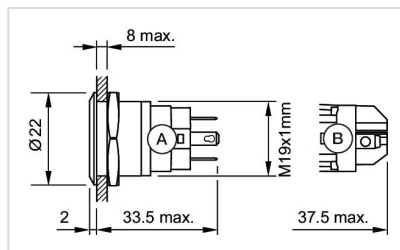

A = Solder terminal
B = Screw terminal

Mounting cut-outs:

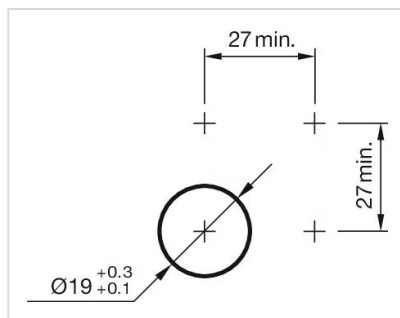

Component layouts:

