

Illuminated pushbutton Ø 19 mm silver contact

82-5552.2113



<https://eao.com/p/82-5552.2113>

Your product:



82-5552.2113

Illuminated pushbutton Ø
19 mm silver contact

FRONT

Front bezel material: Aluminium

Front bezel shape: flush

MOUNTING

Mounting cut-out: Ø 19 mm

OPERATING-/INDICATION PART

Illumination colour: Red

Lens material: Aluminium

Shape of illumination: Ring

Lens colour: Nature

Lens optics: opaque

Lens illumination: illuminative

Lens shape: flush

ELECTRICAL CHARACTERISTICS

Thermal current I_{th}: 5 A

Rated insulation voltage U_i: 250 V

Electrical lifetime: 50 000 cycles of operation

Pollution degree: 2, according to EN IEC 60947-1

Operating voltage: 12 V AC/DC

Electric strength: 1500 VAC, 50 Hz 1 minute between life terminals and ground

Switching voltage and switching current:

according to IEC 60947-5-1 (Silver contacts)		
Service categorie AC-15		
Voltage		Current
24 VAC		1 A
35 VAC		1 A (M12 versio
110 VAC		1 A
220 VAC		0.5 A
Switch rating DC service categorie DC-13 (Silver contacts)		
Voltage		Current
24 VDC		0.7 A
35 VDC		0.5 A (M12 vers
110 VDC		0.2 A
220 VDC		0.1 A

according to UL 508 (Silver contacts)

cosφ 0,75 ... 0,8

Voltage	Current
120 VAC	5 A
240 VAC	3 A
24 VAC	1 A

Rated Operational Voltage Ue: 250 VAC

Contacts: 1 C

MECHANICAL CHARACTERISTIC

Terminal: Screw terminal

Switching action: Maintained

Switching system: Snap-action switching element

Tightening torque: 0.5 ... 0.6 Nm, Screw terminal 0.1 Nm

Weight: 0.018 kg

Operating Travel: ca. 3 mm

Contact material: Silver

Mechanical lifetime: 500 000 cycles of operation

Operating force: 4 N ... 7 N

AMBIENT CONDITION

Vibration resistance: 10 ... 500 Hz, amplitude 1.5 mm p-p according to IEC 60068-2-6

Storage temperature: – 40 °C ... + 80 °C

Climate resistance: Damp heat, 21 days according to IEC 60512-11

Shock resistance: Max. 500 m / s² as per IEC 60068-2-27

Operating temperature: – 30 °C ... + 70 °C

CERTIFICATE

Approbations: CB, CCC, C UL, UL

Conformities: CE, 2011 / 65 / EC (RoHS), 2014 / 35 / EU (LVD)

OTHER

Kind of illumination: Single-LED

Short Description: Illuminated pushbutton Ø 19 mm silver contact, Maintained, 12 V AC/DC, 1 C, Screw terminal, Aluminium, Red, Nature

Mounting cut-outs:

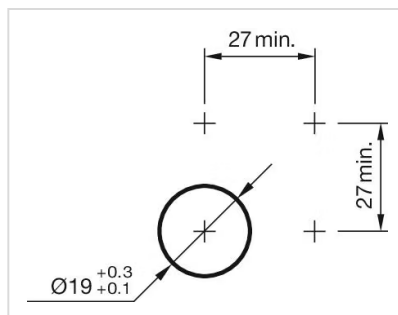

Dimension drawings:

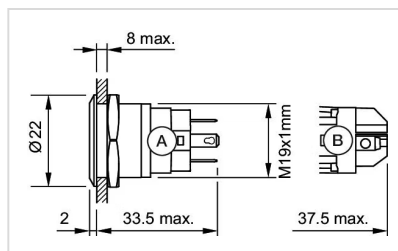

A = Solder terminal
B = Screw terminal

Component layouts:

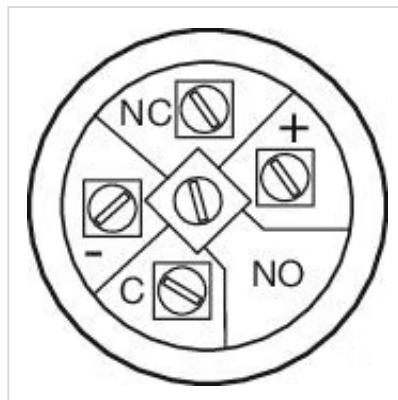

Wiring diagrams:

