

Illuminated pushbutton Ø 19 mm silver contact

82-5552.1124



<https://eao.com/p/82-5552.1124>

Your product:



82-5552.1124

Illuminated pushbutton Ø
19 mm silver contact

FRONT

Front bezel material: Aluminium

Front bezel shape: flush

MOUNTING

Mounting cut-out: Ø 19 mm

OPERATING-/INDICATION PART

Lens optics: opaque

Lens material: Aluminium

Lens illumination: illuminative

Lens colour: Nature

Illumination colour: Blue

Lens shape: flush

Shape of illumination: Ring

ELECTRICAL CHARACTERISTICS

Electrical lifetime: 50 000 cycles of operation

Rated insulation voltage U_i : 250 V

**Switching voltage and switching
current:**

according to IEC 60947-5-1 (Silver contacts)	
Service categorie AC-15	
Voltage	Current
24 VAC	1 A
35 VAC	1 A (M12 version)
110 VAC	1 A
220 VAC	0.5 A
Switch rating DC service categorie DC-13 (Silver contacts)	
Voltage	Current
24 VDC	0.7 A
35 VDC	0.5 A (M12 version)
110 VDC	0.2 A
220 VDC	0.1 A

according to UL 508 (Silver contacts)	
cosφ 0,75 ... 0,8	
Voltage	Current
120 VAC	5 A
240 VAC	3 A
24 VAC	1 A

Operating voltage:	24 V DC
Pollution degree:	2, according to EN IEC 60947-1
Thermal current Ith:	5 A
Rated Operational Voltage Ue:	250 VAC
Contacts:	1 C
Electric strength:	1500 VAC, 50 Hz 1 minute between life terminals and ground

MECHANICAL CHARATERISTIC

Contact material:	Silver
Weight:	0.018 kg
Operating Travel:	ca. 3 mm
Switching action:	Momentary
Terminal:	Screw terminal
Switching system:	Snap-action switching element
Mechanical lifetime:	1 Mio. cycles of operation
Tightening torque:	0.5 ... 0.6 Nm, Screw terminal 0.1 Nm
Operating force:	4 N ... 7 N

AMBIENT CONDITION

Shock resistance:	Max. 500 m / s² as per IEC 60068-2-27
Storage temperature:	– 40 °C ... + 80 °C
Climate resistance:	

Damp heat, 21 days according to IEC 60512-11

Vibration resistance: 10 ... 500 Hz, amplitude 1.5 mm p-p according to IEC 60068-2-6

Operating temperature: - 30 °C ... + 70 °C

CERTIFICATE

Approbations: CB, CCC, C UL, UL

Conformities: CE, 2011 / 65 / EC (RoHS), 2014 / 35 / EU (LVD)

OTHER

Short Description: Illuminated pushbutton Ø 19 mm silver contact, Momentary, 24 V DC, 1 C, Screw terminal, Aluminium, Blue, Nature

Kind of illumination: Single-LED

Component layouts:

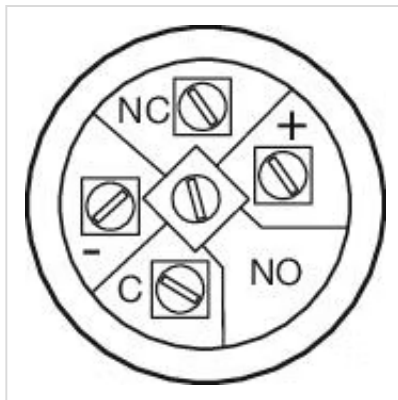

Wiring diagrams:

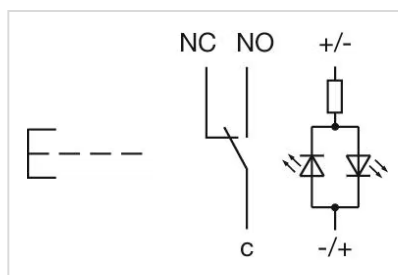

Mounting cut-outs:

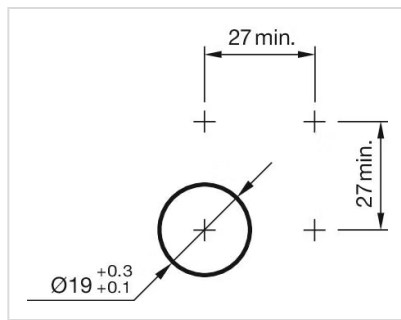

Dimension drawings:

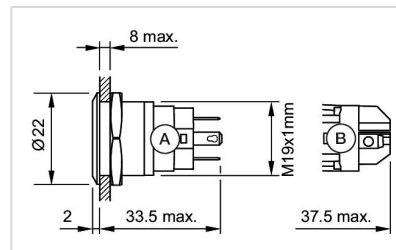

A = Solder terminal
B = Screw terminal