

Illuminated pushbutton Ø 19 mm silver contact

82-5552.2123



<https://eao.com/p/82-5552.2123>

Your product:



82-5552.2123

Illuminated pushbutton Ø
19 mm silver contact

FRONT

Front bezel shape:	flush
Front bezel material:	Aluminium

MOUNTING

Mounting cut-out:	Ø 19 mm
-------------------	---------

OPERATING-/INDICATION PART

Illumination colour:	Blue
Lens illumination:	illuminative
Lens shape:	flush
Shape of illumination:	Ring
Lens optics:	opaque
Lens material:	Aluminium
Lens colour:	Nature

ELECTRICAL CHARACTERISTICS

Pollution degree:	2, according to EN IEC 60947-1
Electric strength:	1500 VAC, 50 Hz 1 minute between life terminals and ground
Operating voltage:	12 V AC/DC
Electrical lifetime:	50 000 cycles of operation
Rated Operational Voltage Ue:	250 VAC
Contacts:	1 C

Thermal current I_{th}:	5 A		
Switching voltage and switching current:	according to IEC 60947-5-1 (Silver contacts) Service categorie AC-15 Voltage 24 VAC 35 VAC 110 VAC 220 VAC Switch rating DC service categorie DC-13 (Silver contacts) Voltage 24 VDC 35 VDC 110 VDC 220 VDC	Current 1 A 1 A (M12 versio 1 A 0.5 A Current 0.7 A 0.5 A (M12 vers 0.2 A 0.1 A	
	according to UL 508 (Silver contacts) cosφ 0,75 ... 0,8 Voltage 120 VAC 240 VAC 24 VAC	Current 5 A 3 A 1 A	

Rated insulation voltage U_i: 250 V

MECHANICAL CHARACTERISTIC

Operating Travel:	ca. 3 mm
Tightening torque:	0.5 ... 0.6 Nm, Screw terminal 0.1 Nm
Weight:	0.018 kg
Switching action:	Maintained
Mechanical lifetime:	500 000 cycles of operation
Switching system:	Snap-action switching element
Contact material:	Silver
Terminal:	Screw terminal
Operating force:	4 N ... 7 N

AMBIENT CONDITION

Storage temperature:	– 40 °C ... + 80 °C
Vibration resistance:	10 ... 500 Hz, amplitude 1.5 mm p-p according to IEC 60068-2-6
Shock resistance:	Max. 500 m / s ² as per IEC 60068-2-27
Operating temperature:	– 30 °C ... + 70 °C
Climate resistance:	Damp heat, 21 days according to IEC 60512-11

CERTIFICATE

Conformities:

CE, 2011 / 65 / EC (RoHS), 2014 / 35 / EU (LVD)

Approbations:

CB, CCC, C UL, UL

OTHER

Kind of illumination:

Single-LED

Short Description:

Illuminated pushbutton Ø 19 mm silver contact, Maintained, 12 V AC/DC, 1 C, Screw terminal, Aluminium, Blue, Nature

Component layouts:

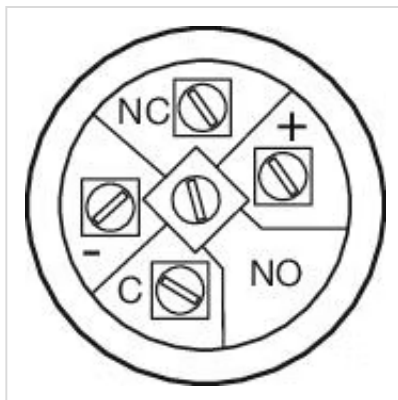

Mounting cut-outs:

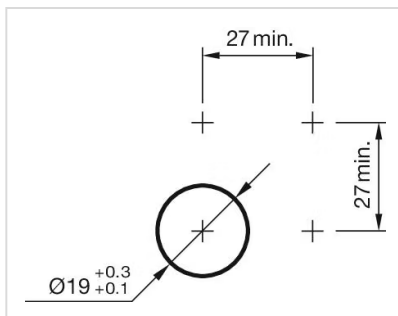

Wiring diagrams:

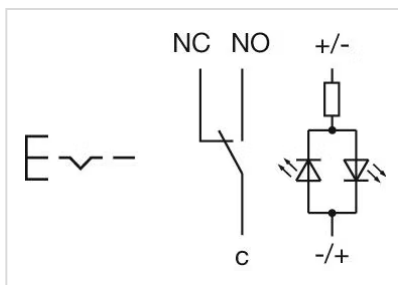

Dimension drawings:

