

Illuminated pushbutton Ø 19 mm silver contact

82-5552.1113



<https://eao.com/p/82-5552.1113>

Your product:



82-5552.1113

Illuminated pushbutton Ø
19 mm silver contact

FRONT

Front bezel shape:	flush
Front bezel material:	Aluminium

MOUNTING

Mounting cut-out:	Ø 19 mm
-------------------	---------

OPERATING-/INDICATION PART

Lens shape:	flush
Lens optics:	opaque
Lens material:	Aluminium
Lens illumination:	illuminative
Illumination colour:	Red
Lens colour:	Nature
Shape of illumination:	Ring

ELECTRICAL CHARACTERISTICS

Electric strength:	1500 VAC, 50 Hz 1 minute between life terminals and ground
Rated insulation voltage Ui:	250 V
Pollution degree:	2, according to EN IEC 60947-1
Contacts:	1 C
Switching voltage and switching current:	

according to IEC 60947-5-1 (Silver contacts)

Service categorie AC-15

Voltage

24 VAC

35 VAC

110 VAC

220 VAC

Current

1 A

1 A (M12 version)

1 A

0.5 A

Switch rating DC service categorie DC-13 (Silver contacts)

Voltage

24 VDC

35 VDC

110 VDC

220 VDC

Current

0.7 A

0.5 A (M12 version)

0.2 A

0.1 A

according to UL 508 (Silver contacts)

$\cos\phi$ 0,75 ... 0,8

Voltage

120 VAC

240 VAC

24 VAC

Current

5 A

3 A

1 A

Thermal current I_{th}:	5 A
Operating voltage:	12 V AC/DC
Electrical lifetime:	50 000 cycles of operation
Rated Operational Voltage U_e:	250 VAC

MECHANICAL CHARACTERISTIC

Weight:	0.018 kg
Operating Travel:	ca. 3 mm
Operating force:	4 N ... 7 N
Switching system:	Snap-action switching element
Terminal:	Screw terminal
Tightening torque:	0.5 ... 0.6 Nm, Screw terminal 0.1 Nm
Mechanical lifetime:	1 Mio. cycles of operation
Switching action:	Momentary
Contact material:	Silver

AMBIENT CONDITION

Storage temperature:	- 40 °C ... + 80 °C
Climate resistance:	Damp heat, 21 days according to IEC 60512-11
Shock resistance:	Max. 500 m / s ² as per IEC 60068-2-27
Vibration resistance:	10 ... 500 Hz, amplitude 1.5 mm p-p according to IEC 60068-2-6
Operating temperature:	

– 30 °C ... + 70 °C

CERTIFICATE

Approbations:

CB, CCC, C UL, UL

Conformities:

CE, 2011 / 65 / EC (RoHS), 2014 / 35 / EU (LVD)

OTHER

Kind of illumination:

Single-LED

Short Description:

Illuminated pushbutton Ø 19 mm silver contact, Momentary, 12 V AC/DC, 1 C, Screw terminal, Aluminium, Red, Nature

Mounting cut-outs:

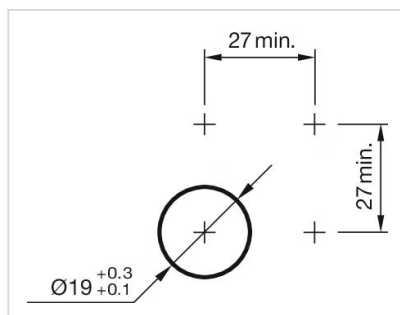

Component layouts:

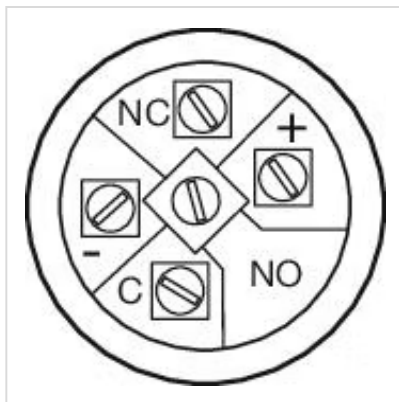

Dimension drawings:

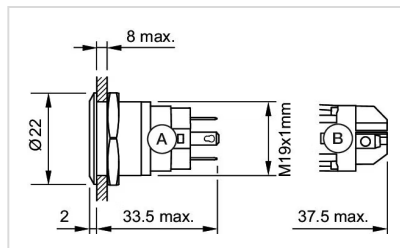

A = Solder terminal
B = Screw terminal

Wiring diagrams:

