

Illuminated pushbutton Ø 19 mm silver contact

82-5152.2114.B001



<https://eao.com/p/82-5152.2114.B001>

Your product:



82-5152.2114.B001

Illuminated pushbutton Ø 19 mm silver contact

FRONT

Front bezel shape:	flush
Front bezel material:	Stainless steel

MOUNTING

Mounting cut-out:	Ø 19 mm
-------------------	---------

OPERATING-/INDICATION PART

Illumination colour:	Red
Lens illumination:	illuminative
Lens material:	Stainless steel
Lens shape:	flush
Lens optics:	opaque
Lens colour:	Silver
Shape of illumination:	Ring

ELECTRICAL CHARACTERISTICS

Electric strength:	1500 VAC, 50 Hz 1 minute between life terminals and ground
Contacts:	1 C
Rated insulation voltage Ui:	250 V
Switching voltage and switching current:	

according to IEC 60947-5-1 (Silver contacts)

Service categorie AC-15

Voltage

24 VAC

35 VAC

110 VAC

220 VAC

Current

1 A

1 A (M12 version)

1 A

0.5 A

Switch rating DC service categorie DC-13 (Silver contacts)

Voltage

24 VDC

35 VDC

110 VDC

220 VDC

Current

0.7 A

0.5 A (M12 version)

0.2 A

0.1 A

according to UL 508 (Silver contacts)

$\cos\phi$ 0,75 ... 0,8

Voltage

120 VAC

240 VAC

24 VAC

Current

5 A

3 A

1 A

Rated Operational Voltage Ue:	250 VAC
Thermal current Ith:	5 A
Operating voltage:	24 V DC
Pollution degree:	2, according to EN IEC 60947-1
Electrical lifetime:	50 000 cycles of operation

MECHANICAL CHARATERISTIC

Terminal:	Screw terminal
Tightening torque:	0.5 ... 0.6 Nm, Screw terminal 0.1 Nm
Operating force:	4 N ... 7 N
Weight:	0.018 kg
Contact material:	Silver
Switching action:	Maintained
Mechanical lifetime:	500 000 cycles of operation
Operating Travel:	ca. 3 mm
Switching system:	Snap-action switching element

AMBIENT CONDITION

Operating temperature:	- 30 °C ... + 70 °C
Storage temperature:	- 40 °C ... + 80 °C
Shock resistance:	Max. 500 m / s ² as per IEC 60068-2-27
Vibration resistance:	

10 ... 500 Hz, amplitude 1.5 mm p-p according to IEC 60068-2-6

Climate resistance: Damp heat, 21 days according to IEC 60512-11

CERTIFICATE

Approbations: CB, CCC, C UL, UL

Conformities: CE, 2011 / 65 / EC (RoHS), 2014 / 35 / EU (LVD)

OTHER

Short Description: Illuminated pushbutton Ø 19 mm silver contact, Maintained, 24 V DC, 1 C, Screw terminal, Stainless steel, Red, ON/OFF, Silver

Kind of illumination: Single-LED

Symbol: ON/OFF

Component layouts:

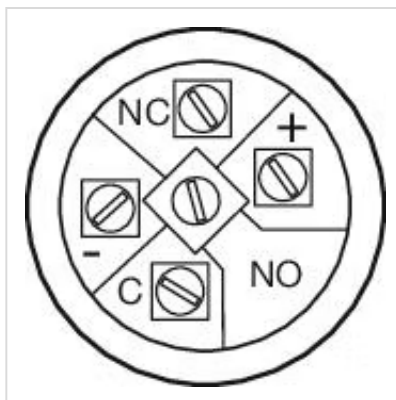

Wiring diagrams:

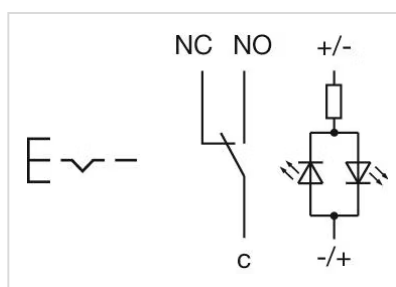

Mounting cut-outs:

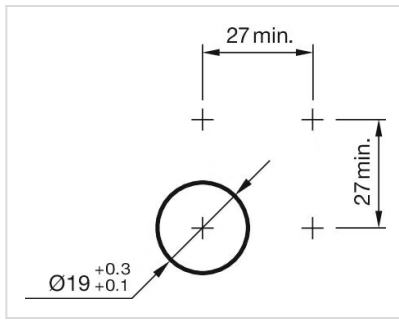

Dimension drawings:



A = Solder terminal
B = Screw terminal