

Illuminated pushbutton Ø 19 mm silver contact

82-5152.2113.B001



<https://eao.com/p/82-5152.2113.B001>

Your product:



82-5152.2113.B001

Illuminated pushbutton Ø 19 mm silver contact

FRONT

| | |
|-----------------------|-----------------|
| Front bezel shape: | flush |
| Front bezel material: | Stainless steel |

MOUNTING

| | |
|-------------------|---------|
| Mounting cut-out: | Ø 19 mm |
|-------------------|---------|

OPERATING-/INDICATION PART

| | |
|------------------------|-----------------|
| Lens material: | Stainless steel |
| Illumination colour: | Red |
| Lens optics: | opaque |
| Lens shape: | flush |
| Lens colour: | Silver |
| Lens illumination: | illuminative |
| Shape of illumination: | Ring |

ELECTRICAL CHARACTERISTICS

| | |
|--|--|
| Thermal current I _{th} : | 5 A |
| Contacts: | 1 C |
| Electric strength: | 1500 VAC, 50 Hz 1 minute between life terminals and ground |
| Rated Operational Voltage U _e : | 250 VAC |
| Rated insulation voltage U _i : | 250 V |
| Operating voltage: | 12 V AC/DC |

| | | | |
|---|--|---------|-----------------|
| Electrical lifetime: | 50 000 cycles of operation | | |
| Pollution degree: | 2, according to EN IEC 60947-1 | | |
| Switching voltage and switching current: | according to IEC 60947-5-1 (Silver contacts) | | |
| | Service categorie AC-15 | | |
| | Voltage | | Current |
| | 24 VAC | | 1 A |
| | 35 VAC | | 1 A (M12 versio |
| | 110 VAC | | 1 A |
| | 220 VAC | | 0.5 A |
| | Switch rating DC service categorie DC-13 (Silver contacts) | | |
| | Voltage | | Current |
| | 24 VDC | | 0.7 A |
| | 35 VDC | | 0.5 A (M12 vers |
| | 110 VDC | | 0.2 A |
| | 220 VDC | | 0.1 A |
| | according to UL 508 (Silver contacts) | | |
| | $\cos\phi$ 0,75 ... 0,8 | | |
| | Voltage | Current | |
| | 120 VAC | 5 A | |
| | 240 VAC | 3 A | |
| | 24 VAC | 1 A | |

MECHANICAL CHARATERISTIC

| | |
|-----------------------------|---------------------------------------|
| Mechanical lifetime: | 500 000 cycles of operation |
| Switching action: | Maintained |
| Terminal: | Screw terminal |
| Operating Travel: | ca. 3 mm |
| Operating force: | 4 N ... 7 N |
| Weight: | 0.018 kg |
| Contact material: | Silver |
| Switching system: | Snap-action switching element |
| Tightening torque: | 0.5 ... 0.6 Nm, Screw terminal 0.1 Nm |

AMBIENT CONDITION

| | |
|-------------------------------|--|
| Shock resistance: | Max. 500 m / s ² as per IEC 60068-2-27 |
| Storage temperature: | – 40 °C ... + 80 °C |
| Climate resistance: | Damp heat, 21 days according to IEC 60512-11 |
| Operating temperature: | – 30 °C ... + 70 °C |
| Vibration resistance: | 10 ... 500 Hz, amplitude 1.5 mm p-p according to IEC 60068-2-6 |

CERTIFICATE

Conformities: CE, 2011 / 65 / EC (RoHS), 2014 / 35 / EU (LVD)

Approbations: CB, CCC, C UL, UL

OTHER

Symbol: ON/OFF

Kind of illumination: Single-LED

Short Description: Illuminated pushbutton Ø 19 mm silver contact, Maintained, 12 V AC/DC, 1 C, Screw terminal, Stainless steel, Red, ON/OFF, Silver

Component layouts:

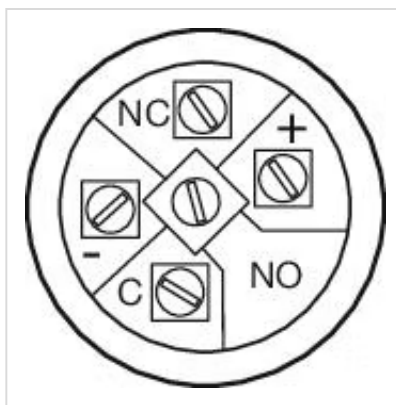

Mounting cut-outs:

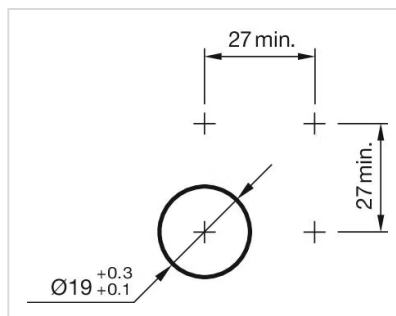

Dimension drawings:

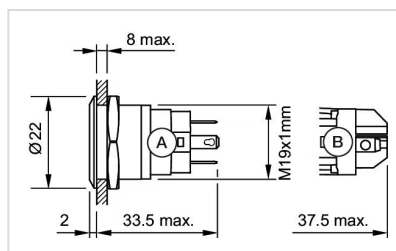

A = Solder terminal
B = Screw terminal

Wiring diagrams:

