

Illuminated pushbutton Ø 16 mm silver contact

82-4552.2113



<https://eao.com/p/82-4552.2113>

Your product:



82-4552.2113

Illuminated pushbutton Ø
16 mm silver contact

FRONT

Front bezel material: Aluminium

Front bezel shape: flush

MOUNTING

Mounting cut-out: Ø 16 mm

OPERATING-/INDICATION PART

Lens shape: flush

Lens optics: opaque

Lens material: Aluminium

Shape of illumination: Ring

Lens colour: Nature

Lens illumination: illuminative

Illumination colour: Red

ELECTRICAL CHARACTERISTICS

Thermal current I_{th}: 5 A

Operating voltage: 12 V AC/DC

Electrical lifetime: 50 000 cycles of operation

**Switching voltage and switching
current:**

| | |
|--|---------------------|
| according to IEC 60947-5-1 (Silver contacts) | |
| Service categorie AC-15 | |
| Voltage | Current |
| 24 VAC | 1 A |
| 35 VAC | 1 A (M12 version) |
| 110 VAC | 1 A |
| 220 VAC | 0.5 A |
| Switch rating DC service categorie DC-13 (Silver contacts) | |
| Voltage | Current |
| 24 VDC | 0.7 A |
| 35 VDC | 0.5 A (M12 version) |
| 110 VDC | 0.2 A |
| 220 VDC | 0.1 A |

| | |
|---------------------------------------|---------|
| according to UL 508 (Silver contacts) | |
| cosφ 0,75 ... 0,8 | |
| Voltage | Current |
| 120 VAC | 5 A |
| 240 VAC | 3 A |
| 24 VAC | 1 A |

| | |
|--------------------------------------|--|
| Rated insulation voltage Ui: | 250 V |
| Rated Operational Voltage Ue: | 250 VAC |
| Pollution degree: | 2, according to EN IEC 60947-1 |
| Contacts: | 1 C |
| Electric strength: | 1500 VAC, 50 Hz 1 minute between life terminals and ground |

MECHANICAL CHARATERISTIC

| | |
|-----------------------------|---------------------------------------|
| Operating Travel: | ca. 3 mm |
| Switching action: | Maintained |
| Mechanical lifetime: | 500 000 cycles of operation |
| Switching system: | Snap-action switching element |
| Terminal: | Screw terminal |
| Tightening torque: | 0.5 ... 0.6 Nm, Screw terminal 0.1 Nm |
| Contact material: | Silver |
| Operating force: | 4 N ... 7 N |
| Weight: | 0.018 kg |

AMBIENT CONDITION

| | |
|-------------------------------|---|
| Shock resistance: | Max. 500 m / s ² as per IEC 60068-2-27 |
| Storage temperature: | – 40 °C ... + 80 °C |
| Operating temperature: | – 30 °C ... + 70 °C |
| Climate resistance: | |

Damp heat, 21 days according to IEC 60512-11

Vibration resistance: 10 ... 500 Hz, amplitude 1.5 mm p-p according to IEC 60068-2-6

CERTIFICATE

Conformities: CE, 2011 / 65 / EC (RoHS), 2014 / 35 / EU (LVD)

Approbations: CB, CCC, C UL, UL

OTHER

Short Description: Illuminated pushbutton Ø 16 mm silver contact, Maintained, 12 V AC/DC, 1 C, Screw terminal, Aluminium, Red, Nature

Kind of illumination: Single-LED

Component layouts:

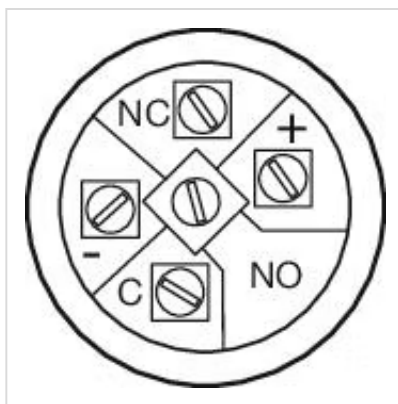

Dimension drawings:

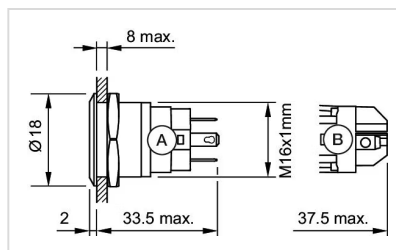

A = Solder terminal
B = Screw terminal

Mounting cut-outs:

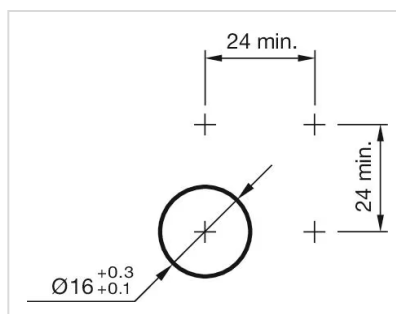

Wiring diagrams:

