

Illuminated pushbutton Ø 16 mm silver contact

82-4552.2114



<https://eao.com/p/82-4552.2114>

Your product:



82-4552.2114

Illuminated pushbutton Ø
16 mm silver contact

FRONT

Front bezel material: Aluminium

Front bezel shape: flush

MOUNTING

Mounting cut-out: Ø 16 mm

OPERATING-/INDICATION PART

Lens illumination: illuminative

Lens shape: flush

Lens material: Aluminium

Lens optics: opaque

Illumination colour: Red

Shape of illumination: Ring

Lens colour: Nature

ELECTRICAL CHARACTERISTICS

Electrical lifetime: 50 000 cycles of operation

Contacts: 1 C

Rated insulation voltage U_i : 250 V

**Switching voltage and switching
current:**

according to IEC 60947-5-1 (Silver contacts)	
Service categorie AC-15	
Voltage	Current
24 VAC	1 A
35 VAC	1 A (M12 version)
110 VAC	1 A
220 VAC	0.5 A
Switch rating DC service categorie DC-13 (Silver contacts)	
Voltage	Current
24 VDC	0.7 A
35 VDC	0.5 A (M12 version)
110 VDC	0.2 A
220 VDC	0.1 A

according to UL 508 (Silver contacts)	
cosφ 0,75 ... 0,8	
Voltage	Current
120 VAC	5 A
240 VAC	3 A
24 VAC	1 A

Electric strength:	1500 VAC, 50 Hz 1 minute between life terminals and ground
Operating voltage:	24 V AC/DC
Thermal current I_{th}:	5 A
Pollution degree:	2, according to EN IEC 60947-1
Rated Operational Voltage U_e:	250 VAC

MECHANICAL CHARACTERISTIC

Operating force:	4 N ... 7 N
Operating Travel:	ca. 3 mm
Tightening torque:	0.5 ... 0.6 Nm, Screw terminal 0.1 Nm
Switching system:	Snap-action switching element
Switching action:	Maintained
Weight:	0.018 kg
Mechanical lifetime:	500 000 cycles of operation
Contact material:	Silver
Terminal:	Screw terminal

AMBIENT CONDITION

Climate resistance:	Damp heat, 21 days according to IEC 60512-11
Vibration resistance:	10 ... 500 Hz, amplitude 1.5 mm p-p according to IEC 60068-2-6
Storage temperature:	– 40 °C ... + 80 °C
Shock resistance:	

Max. 500 m / s² as per IEC 60068-2-27

Operating temperature: - 30 °C ... + 70 °C

CERTIFICATE

Conformities: CE, 2011 / 65 / EC (RoHS), 2014 / 35 / EU (LVD)

Approbations: CB, CCC, C UL, UL

OTHER

Short Description: Illuminated pushbutton Ø 16 mm silver contact, Maintained, 24 V AC/DC, 1 C, Screw terminal, Aluminium, Red, Nature

Kind of illumination: Single-LED

Wiring diagrams:

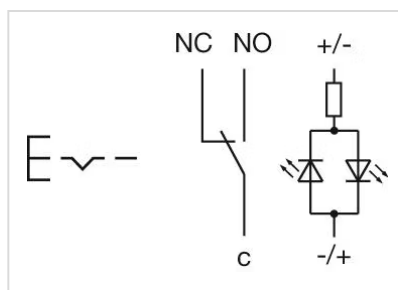

Mounting cut-outs:

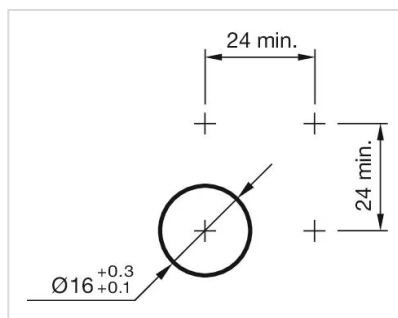

Component layouts:

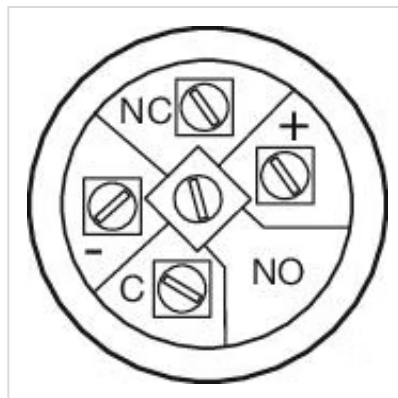

Dimension drawings:

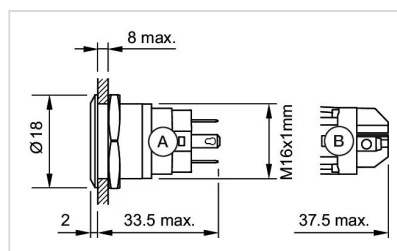

A = Solder terminal

B = Screw terminal