

Switching probe

SKS-465 002 300 A 9002 MF

Item SKS-465-0271



GO TO PRODUCT

ingun[®]

Partner for Future Technology

- For a wide range of applications: performs components detection check, is a switch for detecting closed/open states, and a signal transmitter for process control
- Various collar heights are available on the receptacles to adjust the installation height
- The installation height can be varied, and the position of the switching point can be precisely adjusted via the probe's thread. The SKS is secured in the correct position by crimp point in the KS.
- The electrical connection is ensured by installation using a receptacle, optionally available with a quick-change system for easy exchange during maintenance

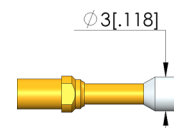
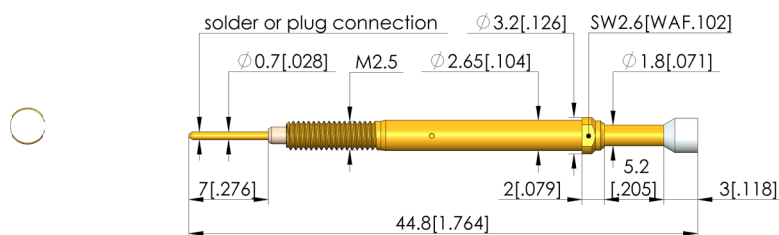
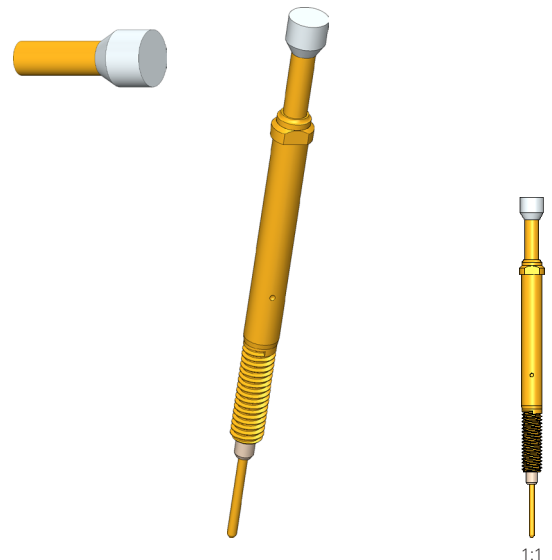

General data

Product group:	Switching probes
Sub-product group:	SKS (screwed-in)
Series:	SKS-465 MF quick-exchange/ plug system, screw-in
Grid:	3.5 mm [137 mil]
Contacting from:	Presence check
Magnetic:	Yes
Installation type:	Screw-in
Quick-exchange system:	Yes
Type of test probe connection:	Plug
Adjustable installation height:	Yes
Non-rotating:	No
Screw-in torque:	3 - 5 cNm [.265 - .442 lbf·in]
Compatible connector(s):	SE-215
Compatible receptacle(s):	KS-465 M, KS-465 M-F
Min. temperature:	- 40 °C [- 104 °F]
Max. temperature:	+ 80 °C [+ 176 °F]
RoHS-compliant:	RoHS-3;6c

Electrical data

Current load capacity / rated current:	3 A
--	-----

Mechanical data

Total length:	44.8 mm [1.76 in]
Barrel diameter:	2.65 mm [.104 in]
Maximum stroke:	5.2 mm [.204 in]
Spring pre-load:	1.28 N [4.60 ozf]
Collar height:	.02
Switch path:	1.7 mm [.066 in]
Switching point:	8.5 mm [.334 in]
Spring force at switching point:	4.5 N [16.1 ozf]

Tip style data

Tip style:	002 flat, contact surface insulated
Tip diameter:	3 mm [.118 in]
Tip style surface:	A gold
Tip style material:	0 plastic

INGUN Prüfmittelbau GmbH

Max-Stromeyer-Straße 162
78467, Constance, Germany
Phone +49 7531 8105-0
Customer hotline +49 7531 8105-888
Fax +49 7531 8105-65
info@ingun.com



Prices and delivery times on request.
Technical changes reserved. 04/24_GB

Learn more about
Test probes



ingun.com