

High-current probe

HSS-621 306 500 A 10002 M

Item HSS-621-0003



GO TO PRODUCT

ingun[®]

Partner for Future Technology

- Trusted high-current probes, optimally sized for current load capacity ratio
- Low resistance probe with Ri typical: < 10 mOhm
- For use in function and burn-in tests
- Large selection of tip styles and spring forces for optimum contact with DUT
- Secure hold in the receptacle due to threaded connection

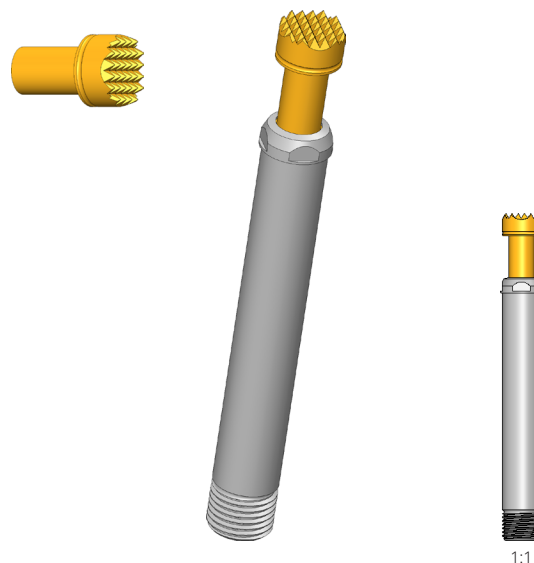

1:1

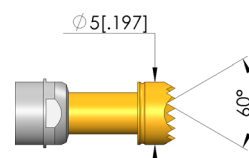
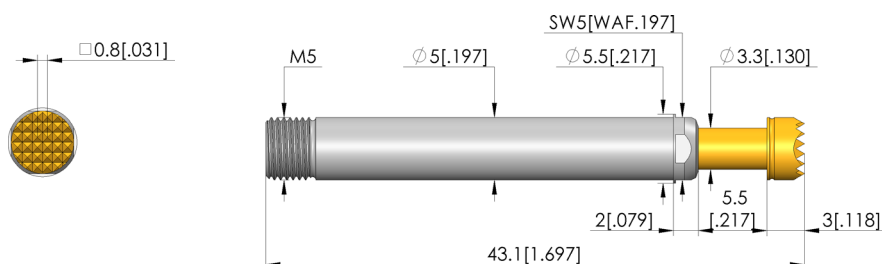

General data

Product group:
Sub-product group:
Series:
Grid:
Contacting from:
Magnetic:
Installation type:
Quick-exchange system:
Adjustable installation height:
Non-rotating:
Screw-in torque:
Compatible receptacle(s):
Min. temperature:
Max. temperature:
RoHS-compliant:

High-current test probe
Standard HSS (screw-in)
HSS-621 M screw-in
6.35 mm [250 mil]
Pin, Post, Flat contact
Yes
Screw-in
Yes
No
No
40 cNm [3.54 lbf-in]
KS-621 M
- 100 °C [- 212 °F]
+ 200 °C [+ 392 °F]
RoHS-3;6c

Electrical data

Current load capacity / rated current:
Typical resistance (Ri):

75 A
<5 mOhm

Mechanical data

Total length:
Barrel diameter:
Maximum stroke:
Spring pre-load:
Collar height:
Spring force at working stroke:
Recommended working stroke:

43.1 mm [1.69 in]
5 mm [.196 in]
5.5 mm [.216 in]
3.97 N [14.2 ozf]
02
10 N [35.9 ozf]
4.4 mm [.173 in]

Tip style data

Tip style:
Tip diameter:
Tip style surface:
Tip style material:

06 serrated
5 mm [.196 in]
A gold
3 CuBe

HIGH-CURRENT TEST PROBE

High-current probe

HSS-621 306 500 A 10002 M

Item HSS-621-0003



ingun[®]

Partner for Future Technology

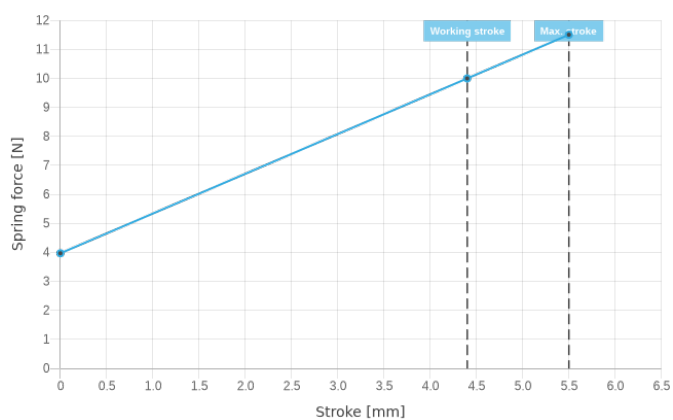

INGUN Prüfmittelbau GmbH

Max-Stromeyer-Straße 162
78467, Constance, Germany
Phone +49 7531 8105-0
Customer hotline +49 7531 8105-888
Fax +49 7531 8105-65
info@ingun.com



Prices and delivery times on request.
Technical changes reserved. 04/24_GB

Learn more about
High-current test probe



HIGH-CURRENT TEST PROBE

ingun.com