

# High-current probe

## HSS-150 319 400 A 5002 M

Item HSS-150-0132



GO TO PRODUCT

**ingun**<sup>®</sup>

Partner for Future Technology

- Trusted high-current probes, optimally sized for current load capacity ratio
- Low resistance probe with Ri typical: < 10 mOhm
- For use in function and burn-in tests
- Large selection of tip styles and spring forces for optimum contact with DUT
- Secure hold in the receptacle due to threaded connection

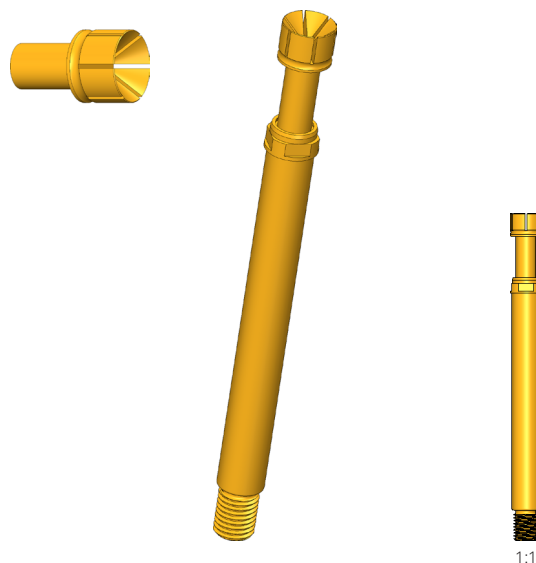

1:1

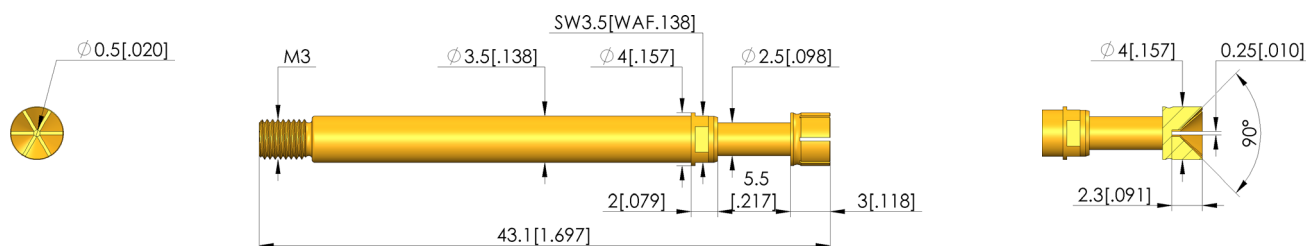

### General data

Product group:  
Sub-product group:  
Series:  
Grid:  
Contacting from:  
Magnetic:  
Installation type:  
Quick-exchange system:  
Adjustable installation height:  
Non-rotating:  
Screw-in torque:  
Compatible receptacle(s):  
Min. temperature:  
Max. temperature:  
RoHS-compliant:

High-current test probe  
Standard HSS (screw-in)  
HSS-150 M screw-in  
5.08 mm [200 mil]  
Pin, posts  
Yes  
Screw-in  
Yes  
No  
No  
10 - 20 cNm [885 - 1.77 lbf·in]  
KS-150 M  
- 100 °C [- 212 °F]  
+ 200 °C [+ 392 °F]  
RoHS-3;6c

### Electrical data

Current load capacity / rated current:  
Typical resistance (Ri):

50 A  
<10 mOhm

### Mechanical data

Total length:  
Barrel diameter:  
Maximum stroke:  
Spring pre-load:  
Collar height:  
Spring force at working stroke:  
Recommended working stroke:

43.1 mm [1.69 in]  
3.5 mm [0.137 in]  
5.5 mm [0.216 in]  
2.18 N [7.84 ozf]  
02  
5 N [17.9 ozf]  
4.4 mm [0.173 in]

### Tip style data

Tip style:  
Tip diameter:  
Tip style surface:  
Tip style material:

19 90° inverse cone, slotted, self cleaning  
4 mm [0.157 in]  
A gold  
3 CuBe

HIGH-CURRENT TEST PROBE

# High-current probe

## HSS-150 319 400 A 5002 M

Item HSS-150-0132



**ingun**<sup>®</sup>

Partner for Future Technology

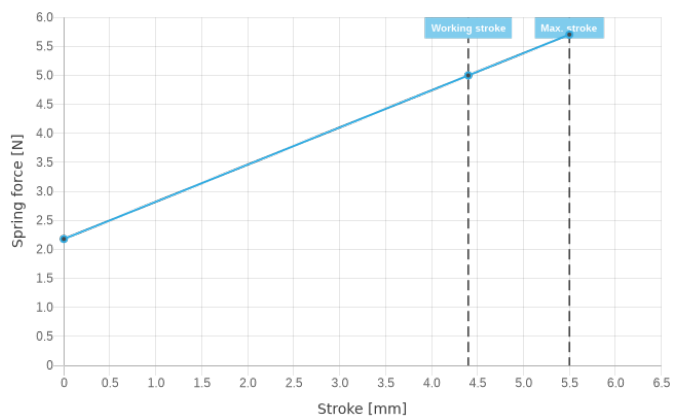

### INGUN Prüfmittelbau GmbH

Max-Stromeyer-Straße 162  
78467, Constance, Germany  
Phone +49 7531 8105-0  
Customer hotline +49 7531 8105-888  
Fax +49 7531 8105-65  
info@ingun.com



Prices and delivery times on request.  
Technical changes reserved. 04/24\_GB

Learn more about  
High-current test probe



ingun.com

HIGH-CURRENT TEST PROBE