

High-current probe

HSS-150 303 400 A 3002

Item HSS-150-0004



GO TO PRODUCT

ingun[®]

Partner for Future Technology

- Trusted, robust high-current probes, optimally sized for current load capacity ratio
- Low resistance probe with Ri typical: < 10 mOhm
- For use in function and burn-in tests
- Large selection of tip styles and spring forces for optimum contact with DUT
- Optimum adjustment of the stroke ratios in the test fixture: The test probe collar is available in different heights, which, in combination with the receptacles, allows a range of installation heights

INGUN SELECTION

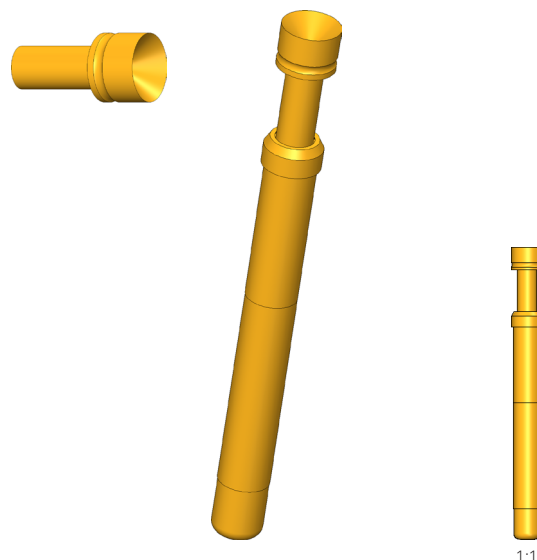

1:1

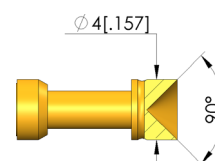
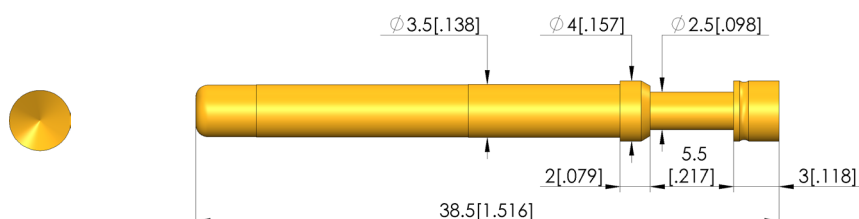

General data

Product group:	High-current test probe
Sub-product group:	Standard HSS (press-in)
Series:	HSS-150
Grid:	5.08 mm [200 mil]
Contacting from:	Pin, posts
Magnetic:	Yes
Installation type:	Plug-in
Quick-exchange system:	Yes
Adjustable installation height:	No
Non-rotating:	No
Compatible receptacle(s):	KS-150
Min. temperature:	- 100 °C [- 212 °F]
Max. temperature:	+ 200 °C [+ 392 °F]
RoHS-compliant:	RoHS-3;6c

Electrical data

Current load capacity / rated current:	50 A
Typical resistance (Ri):	<10 mOhm

Mechanical data

Total length:	38.5 mm [1.51 in]
Barrel diameter:	3.5 mm [.137 in]
Maximum stroke:	5.5 mm [.216 in]
Spring pre-load:	1.31 N [4.71 ozf]
Collar height:	02
Spring force at working stroke:	3 N [10.7 ozf]
Recommended working stroke:	4.4 mm [.173 in]

Tip style data

Tip style:	03 inverse cone
Tip diameter:	4 mm [.157 in]
Tip style surface:	A gold
Tip style material:	3 CuBe

HIGH-CURRENT TEST PROBE

High-current probe

HSS-150 303 400 A 3002

Item HSS-150-0004



ingun[®]

Partner for Future Technology

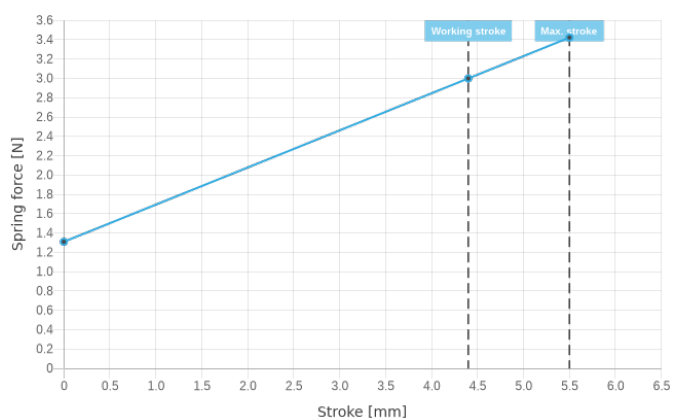

INGUN Prüfmittelbau GmbH

Max-Stromeyer-Straße 162
78467, Constance, Germany
Phone +49 7531 8105-0
Customer hotline +49 7531 8105-888
Fax +49 7531 8105-65
info@ingun.com



Prices and delivery times on request.
Technical changes reserved. 04/24_GB

Learn more about
High-current test probe



ingun.com

HIGH-CURRENT TEST PROBE