

# Radio-frequency probe

## HFS-802 314 051 A 8042 HMTD

Item HFS-802-0001



**ingun**®

Partner for Future Technology

## Radio-frequency contacting

### Contacting of H-MTD connectors

INGUN SELECTION

- For testing differential connectors (e.g. LV 214 / USCAR)
- Used mainly in future technologies for the automotive market (e.g. autonomous driving)
- Consistent radio-frequency performance for data transmission
- Modular design, test probe combination for single, double, or quadruple housing
- Cable interface H-MTD

UTILITY  
MODEL

INGUN  
DESIGN

#### Function / installation

- For H-MTD differential plug connectors (LV 214 / USCAR)
- Consistent radio-frequency performance for data transmission up to 20 Gbit/s
- Modular design, test probe configuration for single, double, or quad housings
- Used mainly in future technologies for the automotive market (e.g. autonomous driving)
- Cable interface via original H-MTD female cable (plastic housing must be removed)

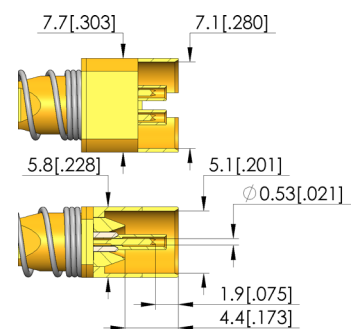
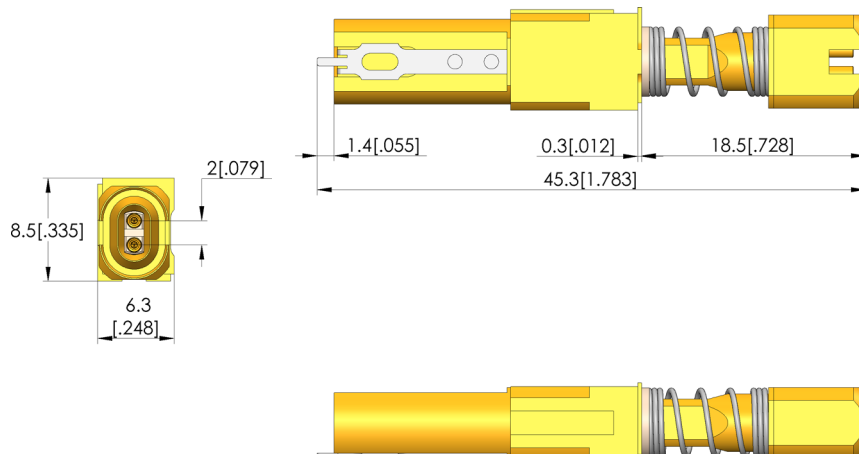
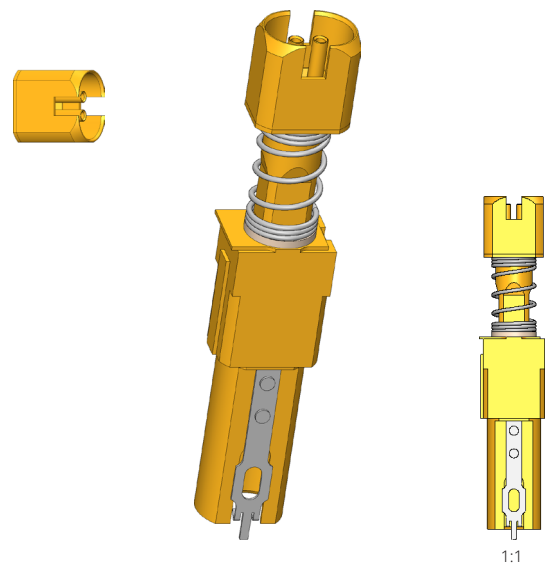

AUTOMOTIVE

# Radio-frequency probe

## HFS-802 314 051 A 8042 HMTD

Item HFS-802-0001



GO TO PRODUCT

**ingun**<sup>®</sup>

Partner for Future Technology

### General data

Product group:	HFS radio-frequency test probes
Series:	HFS-802
Sub-series:	HFS-802
Grid:	8 mm [314 mil]
DUT / contact:	H-MTD ® (Rosenberger) , Ve-NET™(Amphenol)
Installation type:	Plug-in
DUT interface gender :	M signal conductor male / pin
Floating mount:	Yes
Non-rotating:	Yes
Continuous plunger:	Yes
Interface of compatible assembly:	HMTD
Compatible assembly interface gender :	F signal conductor female / socket
KS sub-series:	KS-802 HMTD, press-in version
Min. temperature:	- 40 °C [- 104 °F]
Max. temperature:	+ 80 °C [+ 176 °F]
RoHS-compliant:	RoHS-3;6c

### Outer conductor data

Outer conductor tip style:	42 centring for inner side of plug connector
Outer conductor tip style diameter:	7.7 mm [.303 in]
Spring force of entire outer conductor at working stroke:	6 N [21.5 ozf]
Outer conductor working stroke:	4 mm [.157 in]
Outer conductor maximum stroke:	5 mm [.196 in]
Exchangeable outer conductor:	No
Outer conductor max. current load capacity:	10 A

### Inner conductor data

Inner conductor tip style:	14 4-point crown, self-cleaning
Inner conductor tip style diameter:	0.51 mm [.020 in]
Inner conductor tip style material:	3 CuBe
Inner conductor tip style surface:	A gold
Number of inner conductors:	2 1 differential pair
Exchangeable inner conductor:	No
Inner conductor working stroke:	2.2 mm [.086 in]
Spring force of each inner conductor at working stroke:	1 N [3.59 ozf]
Inner conductor maximum stroke:	2.8 mm [.110 in]
Inner conductor max. current load capacity:	2 A

### Electrical data

Frequency range up to:	3 GHz
Impedance:	100 Ohm

### Mechanical data

Total spring force at working stroke:	8 N [28.7 ozf]
Total length:	44.9 mm [1.76 in]
Barrel diameter:	8 mm [.314 in]
Installation height without receptacle:	18.8 mm [.740 in]

### Hochfrequenz Eigenschaften

Datenrate
20 Gbit/s

### INGUN Prüfmittelbau GmbH

Max-Stromeyer-Straße 162  
78467, Constance, Germany  
Phone +49 7531 8105-0  
Customer hotline +49 7531 8105-888  
Fax +49 7531 8105-65  
info@ingun.com



Prices and delivery times on request.  
Technical changes reserved. 04/24\_GB

Learn more about  
Radio-frequency test probes



AUTOMOTIVE

ingun.com