

# Radio-frequency probe

## HFS-807 308 030 A 6842 HFM-F-M

Item HFS-807-0004



GO TO PRODUCT

**ingun**<sup>®</sup>

Partner for Future Technology

- For testing FAKRA-mini connectors e.g. HFM (Rosenberger) or Mate-AX (TE Connectivity)
- Used mainly in future technologies for the automotive market (e.g. autonomous driving)
- Radio-frequency test probes for best radio frequency performance and data transmission
- Modular design, test probe combination for single, double or quadruple housing can be used or installed in floating mount HAS-807
- Cable interface high-speed SMPM male, connection cable SMPM female

NEW

5G  
READY

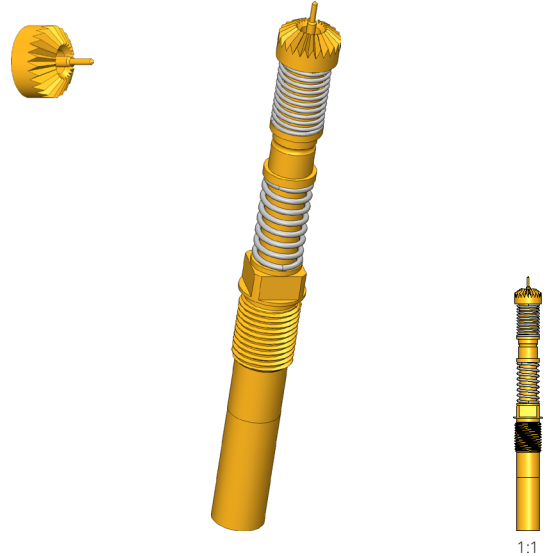

1:1

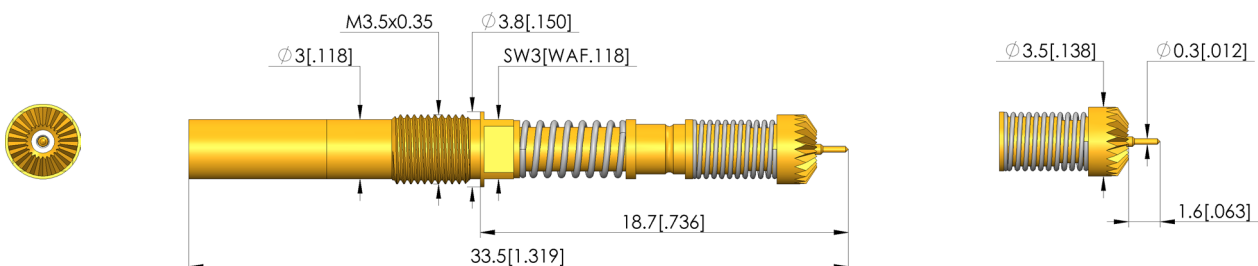

### General data

Product group:	HFS radio-frequency test probes
Series:	HFS-807
Sub-series:	HFS-807 M screw-in
Grid:	4 mm [157 mil]
DUT / contact:	Mini Coax HFM
Installation type:	Screw-in
DUT interface gender :	F signal conductor female / socket
Floating mount:	No
Non-rotating:	No
Continuous plunger:	Yes
Interface of compatible assembly:	SMPM 50 Ohm
Compatible assembly interface gender :	F signal conductor female / socket
Min. temperature:	- 40 °C [- 104 °F]
Max. temperature:	+ 80 °C [+ 176 °F]
RoHS-compliant:	RoHS-3;6c

### Outer conductor data

Outer conductor tip style:	42 centring for inner side of plug connector
Outer conductor tip style diameter:	3.5 mm [.137 in]
Spring force of entire outer conductor at working stroke:	5.8 N [20.8 ozf]
Outer conductor working stroke:	3.2 mm [.125 in]
Outer conductor maximum stroke:	4.1 mm [.161 in]
Exchangeable outer conductor:	No
Outer conductor max. current load capacity:	3 A

# Radio-frequency probe

## HFS-807 308 030 A 6842 HFM-F-M

Item HFS-807-0004



GO TO PRODUCT

**ingun**<sup>®</sup>

Partner for Future Technology

### Inner conductor data

Inner conductor tip style:	08 90°conical, self-cleaning
Inner conductor tip style diameter:	0.3 mm [.011 in]
Inner conductor tip style material:	3 CuBe
Inner conductor tip style surface:	A gold
Number of inner conductors:	1
Exchangeable inner conductor:	No
Inner conductor working stroke:	1 mm [.039 in]
Spring force of each inner conductor at working stroke:	1 N [3.59 ozf]
Inner conductor maximum stroke:	1.5 mm [.059 in]
Inner conductor max. current load capacity:	2 A

### Electrical data

Frequency range up to:	12 GHz
Impedance:	50 Ohm

### Mechanical data

Total spring force at working stroke:	6.8 N [24.4 ozf]
Total length:	33.5 mm [1.31 in]
Barrel diameter:	3 mm [.118 in]
Installation height without receptacle:	18.7 mm [.736 in]
Torque in receptacle:	10 - 20 cNm [.885 - 1.77 lbf·in]

### INGUN Prüfmittelbau GmbH

Max-Stromeyer-Straße 162  
78467, Constance, Germany  
Phone +49 7531 8105-0  
Customer hotline +49 7531 8105-888  
Fax +49 7531 8105-65  
info@ingun.com



Prices and delivery times on request.  
Technical changes reserved. 04/24\_GB

Learn more about  
**Test probes**

