

Spring-loaded test probe

GKS-112 209 060 N 3002 M

Item GKS-112-0127



GO TO PRODUCT

ingun[®]

Partner for Future Technology

- Screw-in test probes for applications with possible vibrations or unwanted side and axial forces (migration of the test probe out of the receptacle is reliably prevented)
- The screw-in test probe is securely installed in the KS using a torque screwdriver and bit tool. The required screw-in torque is applied via a square post on the receptacle.
- Stainless steel versions for temperatures from -100 °C up to +200 °C available

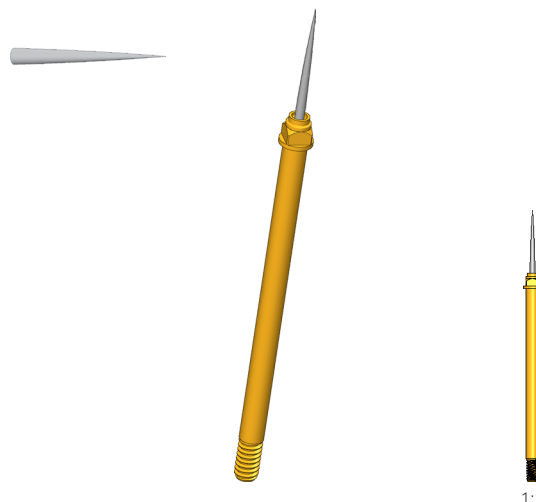

1:1

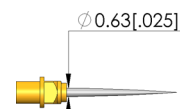
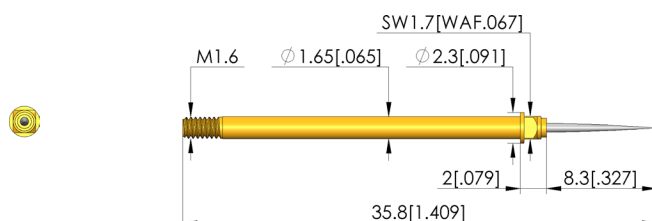

General data

| | |
|---------------------------------|--------------------------------|
| Product group: | Screw-in test probe |
| Sub-product group: | Screw-in test probe |
| Series: | GKS-112 M screw-in |
| Grid: | 2.54 mm [100 mil] |
| Contacting from: | Pad, pin |
| Magnetic: | Yes |
| Installation type: | Screw-in |
| Quick-exchange system: | Yes |
| Adjustable installation height: | No |
| Non-rotating: | No |
| Screw-in torque: | 3 - 5 cNm [.265 - .442 lbf·in] |
| Compatible receptacle(s): | KS-112 M |
| Min. temperature: | - 40 °C [- 104 °F] |
| Max. temperature: | + 80 °C [+ 176 °F] |
| RoHS-compliant: | RoHS-3;6a;6c |

Electrical data

| | |
|--|----------|
| Current load capacity / rated current: | 5 A |
| Typical resistance (Ri): | <20 mOhm |

Mechanical data

| | |
|---------------------------------|-------------------|
| Total length: | 35.8 mm [1.40 in] |
| Barrel diameter: | 1.65 mm [.064 in] |
| Maximum stroke: | 8 mm [.314 in] |
| Spring pre-load: | 1 N [3.59 ozf] |
| Collar height: | 02 |
| Spring force at working stroke: | 3 N [10.7 ozf] |
| Recommended working stroke: | 4 mm [.157 in] |

Tip style data

| | |
|---------------------|--------------------------------|
| Tip style: | 09 flexi-needle, self-cleaning |
| Tip diameter: | 0.6 mm [.023 in] |
| Tip style surface: | N nickel |
| Tip style material: | 2 steel |

Spring-loaded test probe

GKS-112 209 060 N 3002 M

Item GKS-112-0127



ingun[®]

Partner for Future Technology

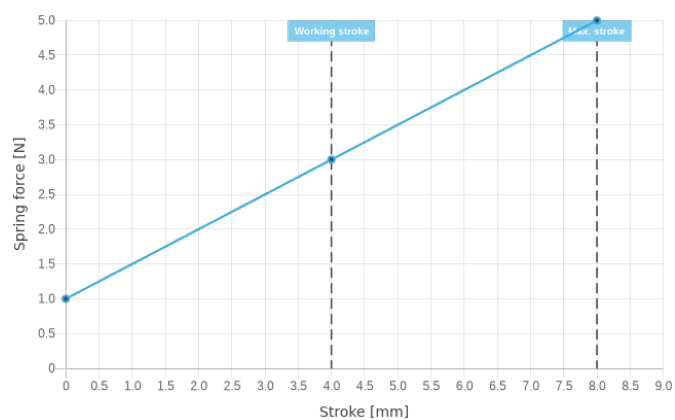

INGUN Prüfmittelbau GmbH

Max-Stromeyer-Straße 162
78467, Constance, Germany
Phone +49 7531 8105-0
Customer hotline +49 7531 8105-888
Fax +49 7531 8105-65
info@ingun.com



Prices and delivery times on request.

Learn more about
ICT/FCT Test probes



ICT/FCT TEST PROBES

ingun.com