

EAO – Your Expert Partner for Human Machine Interfaces

14-435.036 - Illuminated pushbutton actuator

14-435.036 - Illuminated pushbutton actuator

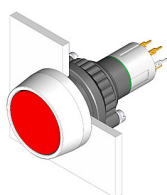

Attention: The preview is based on a sample product. This can differ from your current configuration.

Mounting

Mounting cut-out	Ø 22,3 mm
Design	raised

Front

Front dimension	Ø 29 mm
Front shape	round

Other Attributes

Weight	0,015 kg
--------	----------

Operating-/Indication part

Lens illumination	illuminative
-------------------	--------------

IP-Rating

Front protection	IP67
------------------	------

Connection Method

Terminal	Universal 2.0 x 0.5 mm
----------	------------------------

Actuator

Switching action	Momentary
Housing colour	black
Housing material	Plastic

Switching element

Switching system	Low-level element
Switching current	0.1 A
Contacts	1 NO
Switching voltage	42 V AC/DC
Contact material	

Function

Illuminated pushbutton

EAO – Your Expert Partner for Human Machine Interfaces

14-435.036 - Illuminated pushbutton actuator

Dimensions

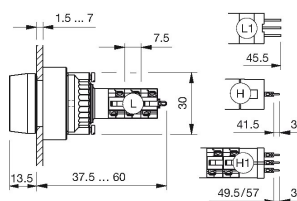

H = Universal terminal 2.0 x 0.5 mm

Mounting cut-outs

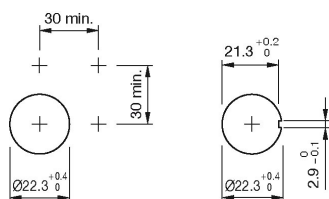

Wiring diagram

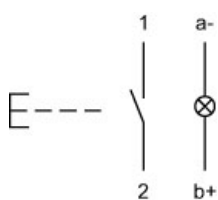

Component layout

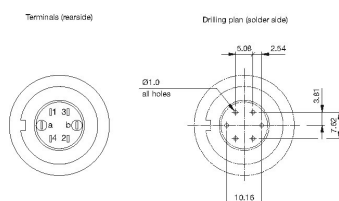

Legend

Contacts: NO = Normally open

Switching action: B = Momentary