

# High-current probe

## HSS-120 303 300 A 2210

Item HSS-120-0122



**ingun**<sup>®</sup>  
Partner for Future Technology

- Trusted, robust high-current probes, optimally sized for current load capacity ratio
- Low resistance probe with Ri typical: < 10 mOhm
- Large selection of tip styles and spring forces for optimum contact with DUT
- Optimum adjustment of the stroke ratios in the test fixture: The test probe collar is available in different heights, which, in combination with the receptacles, allows a range of installation heights

### General data

Product group	High-current test probe
Sub-product group	Standard HSS (press-in)
Series	HSS-120
Grid	4 mm [157 mil]
Contacting from	Pin, Post
Magnetic	Yes
Installation type	Plug-in
Quick-exchange system	Yes
Adjustable installation height	No
Non-rotating	No
Compatible receptacle(s)	KS-113, KS-113 23
Min. temperature	- 100 °C [- 212 °F]
Max. temperature	+ 200 °C [+ 392 °F]
RoHS-compliant	RoHS-3;6c

### Electrical data

Current load capacity / rated current	30 A
Typical resistance (Ri)	<10 mOhm

### Mechanical data

Total length	35.3 mm [1.38 in]
Barrel diameter	2.65 mm [.104 in]
Maximum stroke	5.3 mm [.208 in]
Spring pre-load	0.58 N [2.08 ozf]
Collar height	10
Spring force at working stroke	2.25 N [8.09 ozf]
Recommended working stroke	4 mm [.157 in]

### Tip style data

Tip style	03 inverse cone
Tip diameter	3 mm [.118 in]
Tip style surface	A gold
Tip style material	3 CuBe

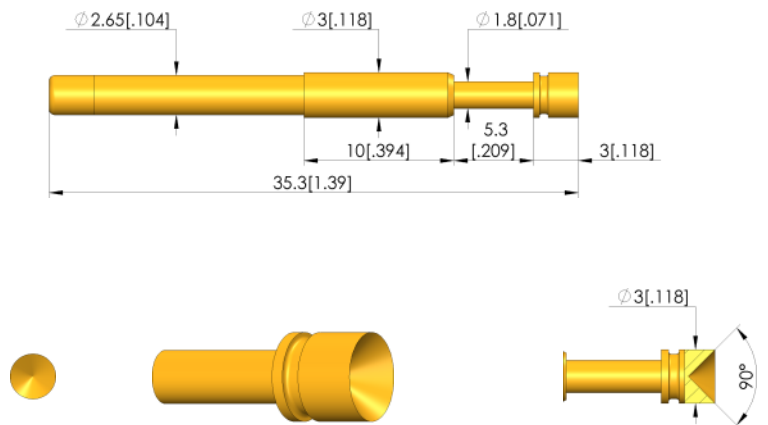
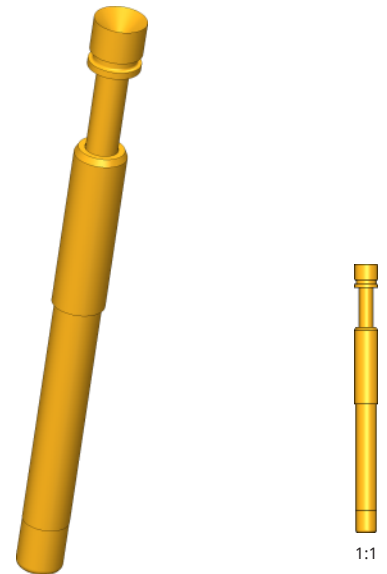

HIGH-CURRENT TEST PROBE

# High-current probe

## HSS-120 303 300 A 2210

Item HSS-120-0122



**ingun**<sup>®</sup>  
Partner for Future Technology

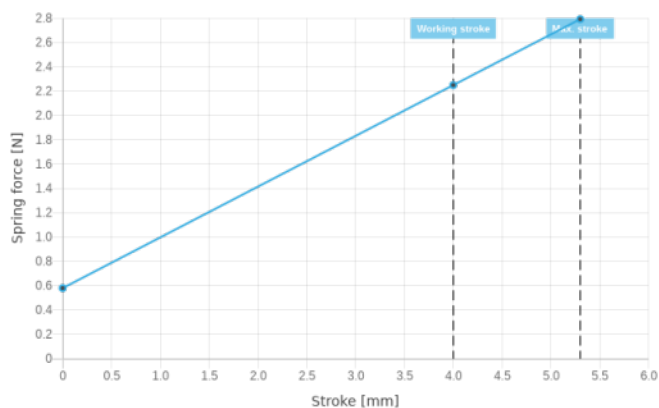

### INGUN Prüfmittelbau GmbH

Max-Stromeyer-Straße 162  
78467, Constance, Germany  
Phone +49 7531 8105-0  
Customer hotline +49 7531 8105-888  
Fax +49 7531 8105-65  
info@ingun.com



Prices and delivery times on request.  
Technical changes reserved. 11/23 EN

Learn more about  
High-current test probe



HIGH-CURRENT TEST PROBE

ingun.com