



- ⬡ IP68 when mated, Tested in accordance with EN60529:1992+A2:2013
- ⬡ IP69K when mated, Tested in accordance with DIN 40050/Part 9 IP69k
- ⬡ EN60068-2-52 Test Kb Salt Mist (Cyclic) Marine Severity Level 1
- ⬡ HDMI 2.1 Performance
- ⬡ Shielded system
- ⬡ Single and double ended cables
- ⬡ Screw coupling
- ⬡ Resolutions and refresh rates of 8K at 60Hz and 4K at 120Hz
- ⬡ Hot pluggable, standard 19 contact interface
- ⬡ Alignment indicator reduces risk of damage during mating
- ⬡ High noise immunity and EMI protection
- ⬡ Secure, proven locking system
- ⬡ Direct mounting or via adaptor leads
- ⬡ Plug and play capability

Sealed HDMI Cables - Single Ended



PX0867

- Single ended sealed cable assembly
- IP68 HDMI connector to standard HDMI connector
- Mates with all panel mount connectors
- Available in 2m, 3m & 5m lengths

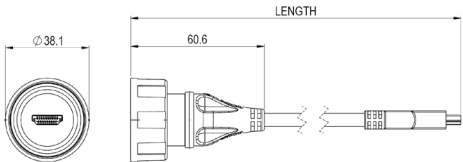

Part no.	Length	Description
PX0867/2M00	2m	IP68 HDMI male to standard HDMI male
PX0867/3M00	3m	IP68 HDMI male to standard HDMI male
PX0867/5M00	5m	IP68 HDMI male to standard HDMI male

Sealed HDMI Cables - Double Ended



PX0868

- Double ended sealed cable assembly
- IP68 HDMI connector to IP68 HDMI connector
- Mates with all panel mount connectors
- Available in 2m, 3m & 5m lengths

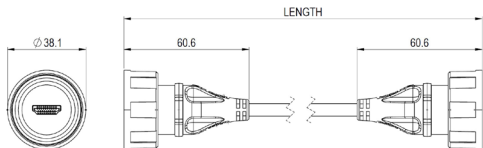

Part no.	Length	Description
PX0868/2M00	2m	IP68 HDMI male to IP68 HDMI male
PX0868/3M00	3m	IP68 HDMI male to IP68 HDMI male
PX0868/5M00	5m	IP68 HDMI male to IP68 HDMI male

Front Panel Mounting Connector



PX0863

- PX0863 – HDMI IP68 connector
- Female HDMI connector at rear of panel
- Mates with PX0867 and PX0868 cable connectors

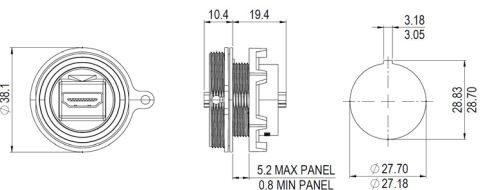

Part no.	Description
PX0863	IP68 HDMI female, front panel mounted. Sealed HDMI at front of panel, standard HDMI type at rear

Front Panel Mounting Connector



PX0863/1M00

- PX0863/1M00 – HDMI IP68 connector with 1m HDMI male lead at rear of panel
- Mates with PX0867 and PX0868 cable connectors

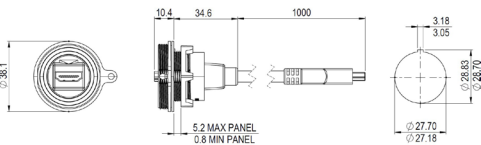

Part no.	Length	Description
PX0863/1M00	1m	IP68 HDMI female with 1m lead, front panel mounted, sealed HDMI at front of panel, standard HDMI at rear

Rear Panel Mounting Connector



PX0869

- PX0869 – HDMI IP68 connector
- Female HDMI connector at rear of panel
- Mates with PX0867 and PX0868 cable connectors

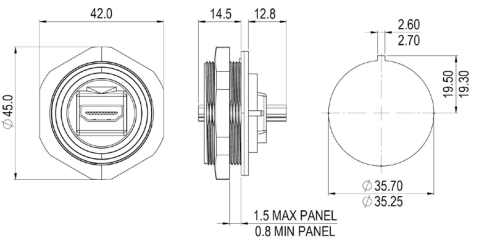

Part no.	Description
PX0869	IP68 HDMI female, rear panel mounted, sealed HDMI at front of panel, standard HDMI type at rear

Rear Panel Mounting Connector



PX0869/1M00

- PX0869/1M00 – HDMI IP68 connector with 1m HDMI male lead at rear of panel
- Mates with PX0867 and PX0868 cable connectors

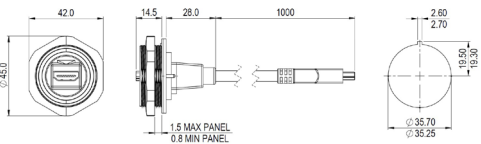

Part no.	Length	Description
PX0869/1M00	1m	IP68 HDMI female, with 1m lead, rear panel mounted, sealed HDMI at front of panel, standard HDMI at rear

Accessories



Sealing Caps

- Sealing caps to maintain IP68 rating when connectors are not in use
- PX0835 for cable connectors PX0867 & PX0868
- PX0733 for front panel mount connectors PX0863, PX0863/1M00
- PX0711 for rear panel mount connectors PX0869, PX0869/1M00

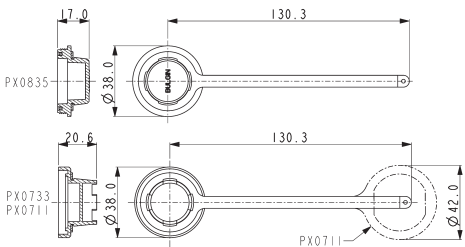

Part no.	Description
PX0835	Sealing Cap for cable connectors (PX0867, PX0868)
PX0733	Sealing Cap for front panel mounting connector (PX0863, PX0863/1M00)
PX0711	Sealing Cap for rear panel mounting connector (PX0869, PX0869/1M00)

Cables & connectors

Mechanical	IP68, EN60529:1992+A2:2013
Sealing	(10m depth for 2 weeks)
	IP69K, Tested in accordance with DIN 40050/Part 9 IP6k9k
Operating temperature	-25°C to +80°C
Salt Mist	EN60068-2-52 Test Kb Salt Mist (Cyclic) Marine Severity Level 1
Electrical	
No. of Contacts	19
Current rating	0.5A
Voltage rating	30V AC (RMS)
Contact resistance	40m Ω max.
Withstanding Voltage	500V AC RMS
Performance	Ultra High Speed HDMI™ Cable with Ethernet

Materials - Overmoulded

Overmould material	PVC (black)
Flammability rating	UL94V-0

Materials - Re-wireable and Panel Connectors

Shell material	Steel
Shell plating	Nickel
Contact material	Brass
Contact plating	Tin & Gold
Connector body & locking ring	Glass Loaded Polyester
Panel connector	Acetal
Flammability rating	UL94 HB
‘O’ rings	Silicone
Panel Gasket - round	Silicone
Panel Gasket - square	Neoprene
Mating cycles	1,000
RoHS	Compliant

Materials - cable

Cable Jacket	PVC (black)
Braid	Aluminium-Magnesium Alloy
Screen Foil	Aluminium Foil
Insulation	HDPE and F-PE
Drain Wire	Tin-Copper Alloy
Flammability Rating	UL94V-0

Length:	Dia	Conductors	
		Signal	Power
		4 x 30AWG	5 x 30AWG
		4 x 30AWG	5 x 30AWG
		1 x 28AWG	4 x 28AWG
2m	6.0mm	3 x 30AWG	1 x 32AWG
3m	6.0mm		
5m	7.3mm		

Cable construction - PX0867, PX0868

