



# WL12-3P2461

## W12-3

SMALL PHOTOELECTRIC SENSORS

**SICK**  
Sensor Intelligence.



Illustration may differ



Ordering information

| Type        | Part no. |
|-------------|----------|
| WL12-3P2461 | 1041452  |

Included in delivery: BEF-KH-W12 (2)  
Other models and accessories → [www.sick.com/W12-3](http://www.sick.com/W12-3)

Detailed technical data

Features

|                                    |                            |                                       |
|------------------------------------|----------------------------|---------------------------------------|
| <b>Functional principle</b>        |                            | Photoelectric retro-reflective sensor |
| <b>Functional principle detail</b> |                            | Autocollimation                       |
| <b>Sensing range max.</b>          |                            | 0 m ... 2 m <sup>1)</sup>             |
| <b>Sensing range</b>               |                            | 0 m ... 1.3 m <sup>1)</sup>           |
| <b>Emitted beam</b>                | Light source               | LED <sup>2)</sup>                     |
|                                    | Type of light              | Visible red light                     |
|                                    | Light spot size (distance) | Ø 2 mm (90 mm)                        |
| <b>Key LED figures</b>             |                            |                                       |
|                                    | Wave length                | 640 nm                                |
| <b>Adjustment</b>                  |                            | Potentiometer, 5 turns                |
| <b>Angle of dispersion</b>         |                            | Approx. 5°                            |
| <b>Special features</b>            |                            | Without polarisation filter           |
| <b>Special applications</b>        |                            | Detecting small objects               |
| <b>Items supplied</b>              |                            | 2 x clamps BEF-KH-W12, incl. screws   |

<sup>1)</sup> Reflector PL80A.  
<sup>2)</sup> Average service life: 100,000 h at T<sub>U</sub> = +25 °C.

Safety-related parameters

|                         |             |
|-------------------------|-------------|
| <b>MTTF<sub>D</sub></b> | 1,388 years |
| <b>DC<sub>avg</sub></b> | 0 %         |

## Electrical data

|                                        |                                                       |
|----------------------------------------|-------------------------------------------------------|
| <b>Supply voltage <math>U_B</math></b> | 10 V DC ... 30 V DC <sup>1)</sup>                     |
| <b>Ripple</b>                          | < 5 V <sub>pp</sub> <sup>2)</sup>                     |
| <b>Current consumption</b>             | 30 mA <sup>3)</sup>                                   |
| <b>Protection class</b>                | III                                                   |
| <b>Digital output</b>                  |                                                       |
| Type                                   | PNP                                                   |
| Signal voltage PNP HIGH/LOW            | > U <sub>v</sub> - 2,5 V / ca. 0 V                    |
| Output current I <sub>max.</sub>       | ≤ 100 mA                                              |
| Response time                          | ≤ 330 μs <sup>4)</sup>                                |
| Switching frequency                    | 1,500 Hz <sup>5)</sup>                                |
| <b>Switching mode</b>                  | Light/dark switching                                  |
| <b>Output function</b>                 | Complementary                                         |
| <b>Circuit protection</b>              | A <sup>6)</sup><br>C <sup>7)</sup><br>D <sup>8)</sup> |
| <b>Special feature</b>                 | Focused optics                                        |

<sup>1)</sup> Limit values when operated in short-circuit protected network: max. 8 A.

<sup>2)</sup> May not exceed or fall below U<sub>v</sub> tolerances.

<sup>3)</sup> Without load.

<sup>4)</sup> Signal transit time with resistive load.

<sup>5)</sup> With light/dark ratio 1:1.

<sup>6)</sup> A = V<sub>S</sub> connections reverse-polarity protected.

<sup>7)</sup> C = interference suppression.

<sup>8)</sup> D = outputs overcurrent and short-circuit protected.

## Mechanical data

|                               |                           |
|-------------------------------|---------------------------|
| <b>Housing</b>                | Rectangular               |
| <b>Dimensions (W x H x D)</b> | 15.6 mm x 48.5 mm x 42 mm |
| <b>Connection</b>             | Male connector M12, 4-pin |
| <b>Material</b>               |                           |
| Housing                       | Metal                     |
| Front screen                  | Plastic, PMMA             |
| <b>Weight</b>                 | 120 g                     |

## Ambient data

|                                      |                              |
|--------------------------------------|------------------------------|
| <b>Enclosure rating</b>              | IP66<br>IP67<br>IP69K        |
| <b>Ambient operating temperature</b> | -40 °C ... +60 °C            |
| <b>Ambient temperature, storage</b>  | -40 °C ... +75 °C            |
| <b>UL File No.</b>                   | NRKH.E181493 & NRKH7.E181493 |

## Classifications

|                     |          |
|---------------------|----------|
| <b>eCl@ss 5.0</b>   | 27270902 |
| <b>eCl@ss 5.1.4</b> | 27270902 |

|                |          |
|----------------|----------|
| eCl@ss 6.0     | 27270902 |
| eCl@ss 6.2     | 27270902 |
| eCl@ss 7.0     | 27270902 |
| eCl@ss 8.0     | 27270902 |
| eCl@ss 8.1     | 27270902 |
| eCl@ss 9.0     | 27270902 |
| eCl@ss 10.0    | 27270902 |
| eCl@ss 11.0    | 27270902 |
| eCl@ss 12.0    | 27270902 |
| ETIM 5.0       | EC002717 |
| ETIM 6.0       | EC002717 |
| ETIM 7.0       | EC002717 |
| ETIM 8.0       | EC002717 |
| UNSPSC 16.0901 | 39121528 |

Connection type

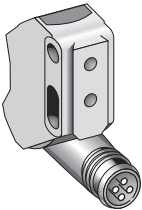

Connection diagram

Cd-083

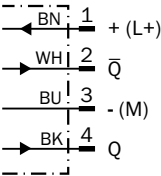

## Characteristic curve

WL12-3, focused

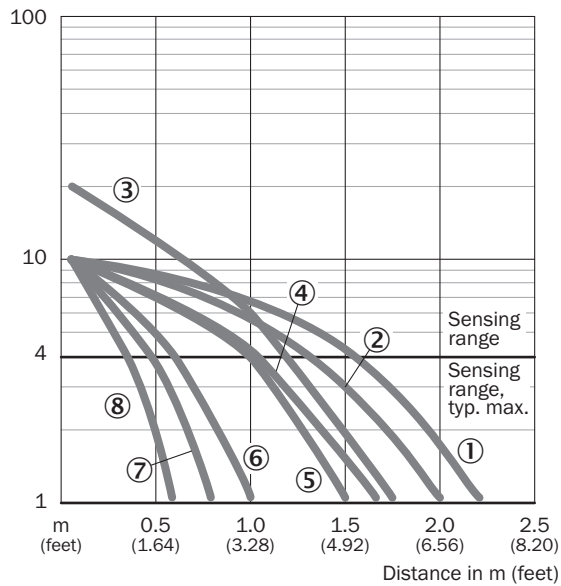

- ① Reflector C110A
- ② Reflector PL80A
- ③ Reflector P250
- ④ Reflector PL50A
- ⑤ Reflector PL40A
- ⑥ Reflector PL30A
- ⑦ Reflector PL20A
- ⑧ Reflector DG/IRF6000

## Sensing range diagram

WL12-3, focused

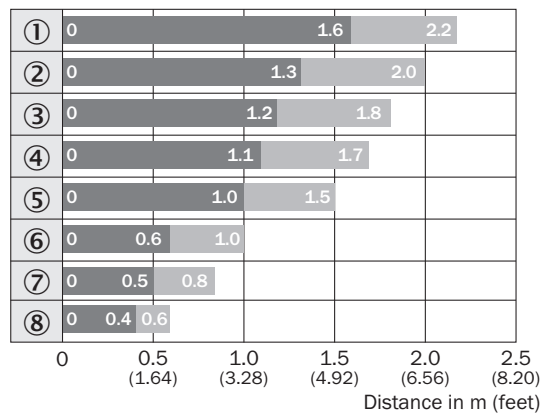

■ Sensing range      ■ Sensing range typ. max.

- ① Reflector C110A
- ② Reflector PL80A
- ③ Reflector P250F
- ④ Reflector PL50A
- ⑤ Reflector PL40A
- ⑥ Reflector PL30A
- ⑦ Reflector PL20A
- ⑧ Reflective tape Diamond Grade

WL12-3, WSE12-3

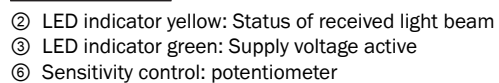



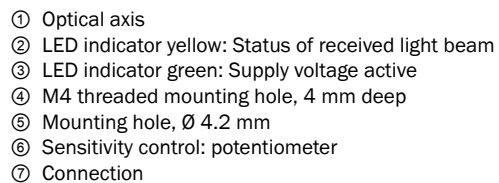

WL12-3, WSE12-3



## Recommended accessories

Other models and accessories → [www.sick.com/W12-3](http://www.sick.com/W12-3)

|                                                                                   | Brief description                                                                                                                     | Type               | Part no. |
|-----------------------------------------------------------------------------------|---------------------------------------------------------------------------------------------------------------------------------------|--------------------|----------|
| Mounting brackets and plates                                                      |                                                                                                                                       |                    |          |
|  | Universal mounting bracket for reflectors, steel, zinc coated                                                                         | BEF-WN-REFX        | 2064574  |
| Plug connectors and cables                                                        |                                                                                                                                       |                    |          |
|  | Head A: female connector, M12, 4-pin, straight, A-coded<br>Head B: Flying leads<br>Cable: Sensor/actuator cable, PVC, unshielded, 5 m | YF2A14-050VB3XLEAX | 2096235  |
|  | Head A: male connector, M12, 4-pin, straight<br>Cable: unshielded                                                                     | STE-1204-G         | 6009932  |
| Reflectors                                                                        |                                                                                                                                       |                    |          |
|  | Rectangular, screw connection, 18 mm x 60 mm, PMMA/ABS, Screw-on, 2 hole mounting                                                     | PL20A              | 1012719  |

## SICK AT A GLANCE

SICK is one of the leading manufacturers of intelligent sensors and sensor solutions for industrial applications. A unique range of products and services creates the perfect basis for controlling processes securely and efficiently, protecting individuals from accidents and preventing damage to the environment.

We have extensive experience in a wide range of industries and understand their processes and requirements. With intelligent sensors, we can deliver exactly what our customers need. In application centers in Europe, Asia and North America, system solutions are tested and optimized in accordance with customer specifications. All this makes us a reliable supplier and development partner.

Comprehensive services complete our offering: SICK LifeTime Services provide support throughout the machine life cycle and ensure safety and productivity.

For us, that is “Sensor Intelligence.”

## WORLDWIDE PRESENCE:

Contacts and other locations –[www.sick.com](http://www.sick.com)