



SS220

**1/2" Square Drive Stainless Steel
Sockets with Metric Hex Profile**



PRODUCT DETAILS

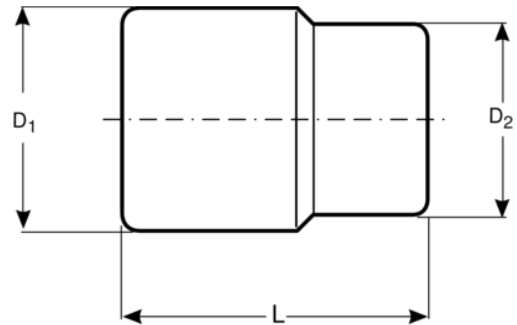

- AISI 420 stainless steel body
- Magnetic
- High strength and hardness
- Can be Autoclave Sterilized at 121°C
- Produced according to ISO 1174-1, ISO 1171-1 and ISO 2725-1



Follow the Fish!



PRODUCT ATTRIBUTES

Product		L	D1	D2	
SS220-8	8 mm	40 mm	24 mm	15 mm	80 g
SS220-9	9 mm	40 mm	24 mm	16 mm	80 g
SS220-10	10 mm	40 mm	24 mm	17 mm	80 g
SS220-11	11 mm	40 mm	24 mm	18 mm	80 g
SS220-12	12 mm	40 mm	24 mm	19 mm	80 g
SS220-13	13 mm	40 mm	24 mm	20 mm	70 g
SS220-14	14 mm	40 mm	24 mm	21 mm	70 g
SS220-15	15 mm	40 mm	25 mm	23 mm	85 g
SS220-16	16 mm	40 mm	25 mm	24 mm	90 g
SS220-17	17 mm	40 mm	25 mm	25 mm	95 g
SS220-18	18 mm	42 mm	25 mm	26 mm	95 g
SS220-19	19 mm	42 mm	25 mm	28 mm	120 g
SS220-20	20 mm	42 mm	26 mm	29 mm	110 g
SS220-21	21 mm	43 mm	26 mm	30 mm	120 g
SS220-22	22 mm	43 mm	26 mm	31 mm	130 g
SS220-23	23 mm	43 mm	26 mm	33 mm	140 g
SS220-24	24 mm	43 mm	28 mm	34 mm	150 g
SS220-25	25 mm	43 mm	28 mm	36 mm	160 g
SS220-26	26 mm	43 mm	30 mm	37 mm	180 g
SS220-27	27 mm	46 mm	30 mm	38 mm	210 g
SS220-28	28 mm	46 mm	30 mm	39 mm	220 g
SS220-29	29 mm	46 mm	30 mm	41 mm	230 g
SS220-30	30 mm	46 mm	30 mm	42 mm	240 g
SS220-31	31 mm	46 mm	34 mm	43 mm	250 g
SS220-32	32 mm	46 mm	34 mm	44 mm	260 g

Follow the Fish!

