

Tube Cutter for Steel

7918-A0

- For steel pipes
- Strong cast housing
- Extra-long shank provides for quick & easy adjustment
- Possible for large pipe sizes
- Perfectly balanced



| KT NO. | inch | mm | max. (mm) | inch | Overall length mm | | |
|-----------|---------------------|--------|-----------|--------|-------------------|------|---------|
| 7918-A0 | 1-11/32~3-9/16 | 43~114 | 3 | 28-1/8 | 900 | 5020 | 1 / 4 |
| 7918-A011 | Spare cutting blade | | | | | 66 | 1 / 200 |

Ratchet Tubing Cutter for Stainless Steel

7912-21

7912-22

- Cuts without having to rotate tool completely around tubing
- Ratchet mechanism allows for tight area operation
- Cuts through some of the toughest surfaces: stainless steel, wall conduit, copper and aluminum
- Exclusive one hand operation, limited risks of hand-fatigue and injuries



- Comes with spare blade.
- Provided with foldable reamer.

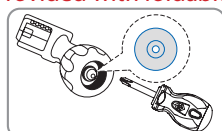

- Use Phillips screwdriver to take out the back-up blade located in the handle base.

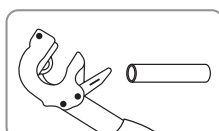

- Deploy foldable reamer provided to smoothen sharp edges. (only 7912-22)



| KT NO. | Capacity ø mm | Max. cutting thickness (mm) | | Remark | | |
|-----------|---------------------|-----------------------------|-------|----------------------|-----|----------|
| | | Stainless | Other | | | |
| 7912-21 | 8-28 | 2 | 3.0 | spare blade | 389 | 1 / 40 |
| 7912-22 | 12-35 | 2 | 3.0 | spare blade / reamer | 452 | 1 / 40 |
| 7912-0111 | Spare cutting blade | | | | 5 | 25 / 250 |

7912-23

- Apply to cut car's exhaust pipe.

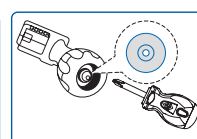
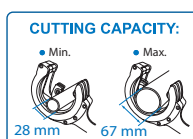
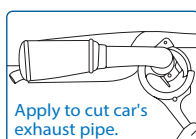

- Use Phillips screwdriver to take out the back-up blade located in the handle base.

| KT NO. | Capacity ø mm | Max. cutting thickness (mm) | | | |
|-----------|---------------------|-----------------------------|-------|--------|----------|
| | | Stainless | Other | | |
| 7912-23 | 28-67 | 2 | 3.0 | 1122.6 | 1 / 10 |
| 7912-2311 | Spare cutting blade | | | 5 | 25 / 250 |