



SERIES WSA50 - PUSHBUTTON SWITCHES

Series WSA50

KEY FEATURES

- Size: 16mm
- SPDT : 1NO / 1NC
- Mechanical Life: 25k Cycle Nominal
- Snap Action: Momentary
- Operation temperature: -40 ~ 85°C
- Plastic Housing
- IP67 water proof
- 5A / 28VDC with UL 61058

APPLICATIONS

- Office equipment
- Medical Equipment
- Industrial Machinery
- Mass transportation
- Food Processing Equipment
- Office Equipment
- Joystick Control

ORDERING INFORMATION

WSA50 - - - - - - -

Switch Function / Termination:	
1	Momentary, Solder
A	Momentary, NO/NO Wireleads
C	Momentary, NC/NC Wireleads
E	Momentary, NC/NO Wireleads

Housing Type:	
RBK	Round, Black

LED Color:	
N	None
R	Red
G	Green
Y	Yellow
B	Blue
W	White

Button Color:	
RD	Red
GR	Green
BK	Black
BL	Blue
YL	Yellow
OR	Orange

Mounting Type:	
B	Bushing

Voltage Resistor:	
If Blank: Note*	
05	5V Forward
12	12V Forward**
24	24V Forward**

Special Request:	
If Blank: N/A	
xxx	Customer Special Request

Note:

* Current limiting resistor is required to limit LED forward current to 20mA.(not included)

**12 and 24V resistors are available with wirelead versions only.

SERIES WSA50 - PUSHBUTTON SWITCHES

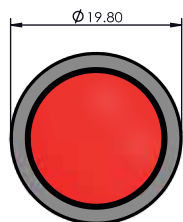

NON-ILLUMINATION TYPE

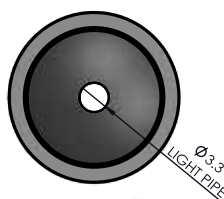

ILLUMINATION TYPE

WSA50 SERIES

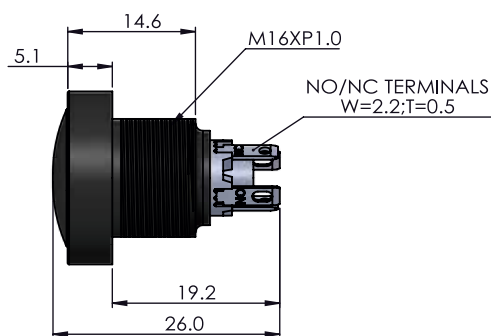

NON-ILLUMINATION

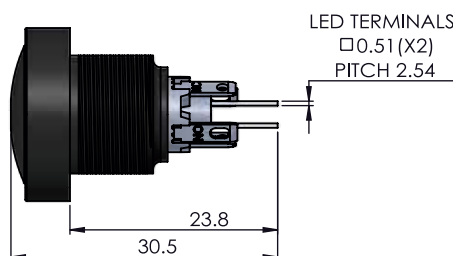

ILLUMINATION

WIRELEADS

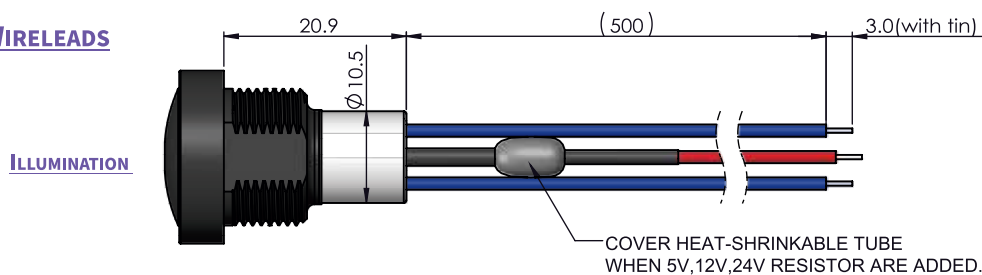

ILLUMINATION

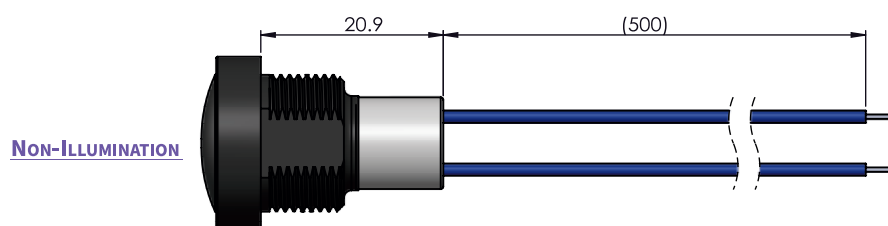

NON-ILLUMINATION

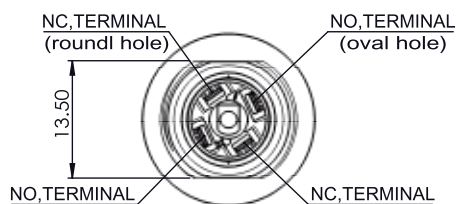

DETAIL FOR TERMINAL POSITION

RECOMMENDED PANEL CUT-OUT	
PANEL THICKNESS	0.020~0.117" [0.5~3.0 mm]
NUT TORQUE FORCE	Max. 5.2 lb-in [6.0 kgf-cm]

LED CODE	LED COLOR	CIRCUITRY	Vf (VDC)	If (mA)
R	RED		1.8~2.5	20
B	BLUE		2.8~3.5	20
G	GREEN		2.8~3.5	20
Y	YELLOW		1.8~2.5	20
W	WHITE		2.8~3.5	20

Notes:
1. Lead Soldering Temperature (4mm above from body) : 280°C for 5 seconds
2. Hand Soldering Temperature (4mm above from body) : 320°C for 3 seconds

WIRELEADS TYPE	SW TERMINAL		LED	
	NO	NC	+	-
ILLUMINATION	BLUE AWG24 UL1007	YELLOW AWG24 UL1007	RED AWG26 UL1007	BLACK AWG26 UL1007
NON-ILLUMINATION	BLUE AWG24 UL1007	YELLOW AWG24 UL1007	-	-

MECHANICAL CHARACTERISTICS

- Switch Circuitry: SPDT-DB (Form X)
- Pretravel (Nominal): 0.050 inches [1.27mm]
- Overtravel (Nominal): 0.010 inches [0.25mm]
- Total Travel (Nominal): 0.060 inches [1.52mm]
- Operating Force (Nominal): 5.15N [525g]
- Release Force (Nominal): 3.45N [340g]
- Contacts Material: Silver
- Panel Thickness: 0.020" - 0.117" [0.5 - 3.0mm]
- Nut Torque Force: Max 5.2 lb-in [6.0 kgf-cm]
- Current Ratings (Nominal): 5A @ 28VDC, 25k Cycles

ENVIROMENTAL SPECIFICATIONS

- Operating Temperature: -40°F to +185°F (-40°C to +85°C)
- Water Proof: IP67 (Front Panel)

ELECTRICAL SPECIFICATIONS

- Dielectric Strength: 1,000VAC
- Insulation Resistance: 1G Ω
- Contacts Resistance: 50 mΩ max. (Non-Wirelead)
250 mΩ max. (Wirelead)