

# Standard Impact Socket

9535M

1-1/2"

▪ DIN 3129

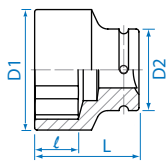

9535S

1-1/2"

▪ ANSI / ASME B107.1

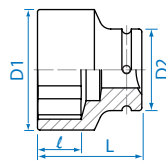

KT NO.	mm	D1 mm	D2 mm	mm	L mm	Kg	1/6
953532M	32	56	86	23	80	1.393	1 / 6
953533M	33	57	86	23	80	1.952	1 / 6
953534M	34	58	86	24	80	1.923	1 / 6
953536M	36	62	86	26	80	1.994	1 / 6
953538M	38	64	86	26	80	2.001	1 / 6
953541M	41	68	86	28	80	2.056	1 / 6
953542M	42	70	86	28	80	2.081	1 / 6
953546M	46	73	86	30	85	2.154	1 / 6
953550M	50	78	86	32	85	2.246	1 / 6
953555M	55	85	86	36	93	2.520	1 / 6
953560M	60	90	86	40	95	2.757	1 / 6
953565M	65	96	86	42	100	3.134	1 / 6
953570M	70	103	86	46	103	3.529	1 / 6
953575M	75	108	86	48	105	3.713	1 / 4
953580M	80	115	86	52	105	3.934	1 / 4
953585M	85	121	86	55	110	4.467	1 / 4
953590M	90	127	86	58	110	4.652	1 / 4
953595M	95	134	127	50	110	7.224	1 / 1
9535A0M	100	140	127	53	115	7.729	1 / 1
9535A5M	105	146	127	53	115	7.856	1 / 1
9535B0M	110	152	127	56	125	8.845	1 / 1
9535B5M	115	160	127	60	125	9.454	1 / 1
9535C0M	120	166	127	62	130	9.960	1 / 1
9535C5M	125	172	127	65	135	10.826	1 / 1
9535D0M	130	180	127	68	140	12.423	1 / 1
9535D5M	135	185	127	70	145	13.240	1 / 1
9535E0M	140	190	127	75	150	13.570	1 / 1
9535F0M	150	200	127	80	155	14.270	1 / 1

KT NO.	inch	D1 mm	D2 mm	mm	L mm	Kg	1/6
953564S	2	81	86	35	85	2.305	1 / 6
953566S	2-1/16	82	86	36	85	2.364	1 / 6
953568S	2-1/8	84	86	36	90	2.508	1 / 6
953570S	2-3/16	85	86	43	93	3.204	1 / 6
953572S	2-1/4	87	86	43	93	5.209	1 / 6
953574S	2-5/16	89	86	43	93	2.560	1 / 6
953576S	2-3/8	90	86	45	95	2.622	1 / 6
953578S	2-7/16	93	86	44	95	2.711	1 / 6
953580S	2-1/2	95	86	46	97	2.833	1 / 6
953582S	2-9/16	96	86	49	100	2.863	1 / 6
953584S	2-5/8	99	86	48	100	2.958	1 / 6
953586S	2-11/16	101	86	48	100	3.055	1 / 6
953588S	2-3/4	103	86	48	103	3.217	1 / 6
953590S	2-13/16	105	86	50	105	3.306	1 / 6
953592S	2-7/8	107	86	50	105	3.600	1 / 6
953594S	2-15/16	108	86	50	105	3.455	1 / 6
953596S	3	111	86	50	105	3.590	1 / 4
953598S	3-1/16	114	86	52	105	3.931	1 / 4
9535A0S	3-1/8	116	86	53	105	4.123	1 / 4
9535A2S	3-3/16	118	86	53	105	4.089	1 / 4
9535A4S	3-1/4	120	86	54	105	4.829	1 / 4
9535A6S	3-5/16	122	86	56	105	4.207	1 / 4
9535A8S	3-3/8	123	86	56	105	4.306	1 / 4
9535B0S	3-7/16	125	86	57	105	4.256	1 / 4
9535B2S	3-1/2	129	86	60	110	4.905	1 / 4
9535B4S	3-9/16	130	86	60	110	5.435	1 / 4
9535B6S	3-5/8	131	86	60	110	4.894	1 / 4
9535B8S	3-11/16	133	86	62	113	5.468	1 / 1
9535C0S	3-3/4	136	127	62	113	3.741	1 / 1
9535C2S	3-13/16	138	127	64	120	9.098	1 / 1
9535C4S	3-7/8	139	127	66	120	8.954	1 / 1
9535C6S	3-15/16	140	127	66	120	8.931	1 / 1
9535C8S	4	142	127	66	120	7.886	1 / 1
9535D0S	4-1/16	143	127	68	120	7.843	1 / 1
9535D2S	4-1/8	146	127	68	120	8.003	1 / 1
9535D4S	4-3/16	146	127	70	120	7.851	1 / 1
9535D6S	4-1/4	150	127	72	124	8.385	1 / 1
9535D8S	4-5/16	154	127	72	124	8.973	1 / 1
9535E0S	4-3/8	155	127	72	124	8.923	1 / 1
9535E2S	4-7/16	155	127	75	128	9.033	1 / 1
9535E4S	4-1/2	159	127	75	128	9.258	1 / 1
9535E8S	4-5/8	164	127	79	132	13.730	1 / 1
9535F2S	4-3/4	167	127	79	132	10.386	1 / 1
9535F6S	4-7/8	171	127	79	136	10.930	1 / 1
9535G0S	5	174	127	79	140	11.338	1 / 1
9535G4S	5-1/8	180	127	80	143	12.279	1 / 1
9535G8S	5-1/4	184	127	80	145	12.728	1 / 1
9535J2S	6	203	127	85	165	14.270	1 / 1

