



www.jbctools.com

INSTRUCTION MANUAL



RHN

Rework Hand Support for PHNK

This manual corresponds to the following reference:

RHN-A

Packing List

The following items are included:



Hand Support Arm 1 unit
Ref. HRR-A



Height Adjustment Flange 1 unit
Ref. 0023991



Shaft 1 unit



Base PHN compatible 1 unit



Headless Screw 1 unit
Ref. 0017057



Allen Key 1 unit
Ref. 0013609



Manual 1 unit
Ref. 0027888

Features

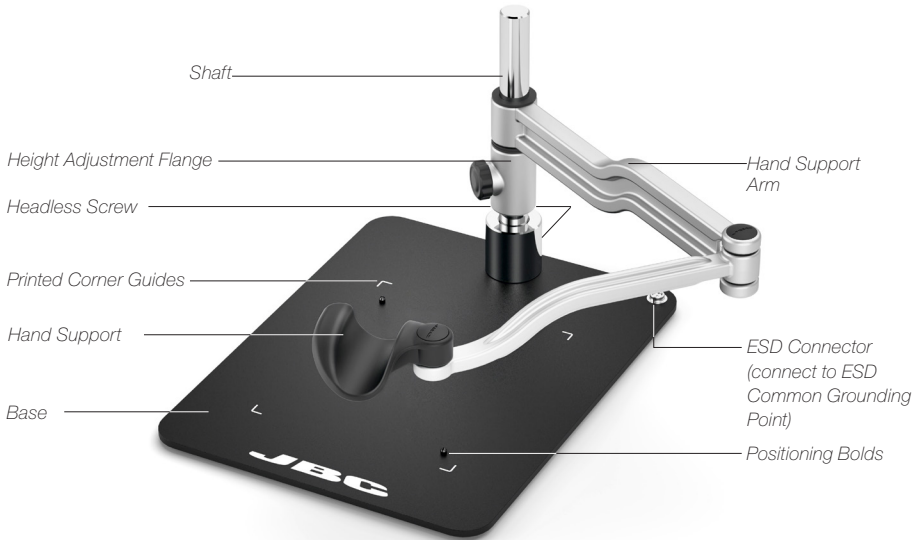

Assembly

Setting up the Hand Support Arm

Fit the shaft into the base bushing (1) and tighten the headless screw (2). Then assemble first the height adjustment flange (3) and finally the hand support arm (4) onto the shaft.

The hand support arm position should be as shown in the image. The right hand support is marked at its bottom side with the letter "R".

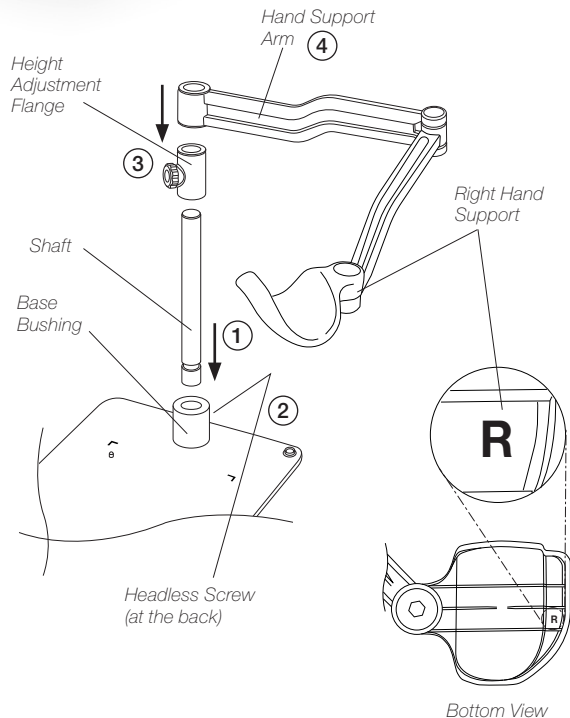

Height Adjustment

According to your work needs the hand support arm allows adjustment for different heights through the vertical axis.

Slide the arm to the appropriate height (1) and secure by tightening the knob (2) to guarantee stability.

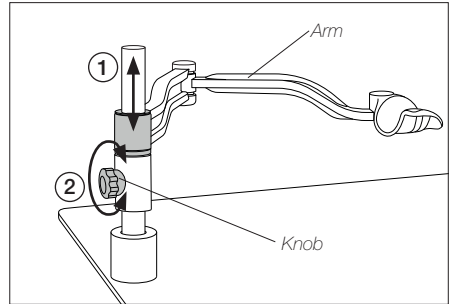

Work Position Adjustment

RHN arm allows adjustment for different positions according to your work needs. The articulated arm covers all work areas.

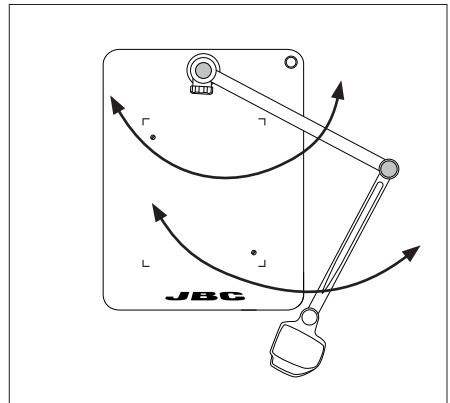
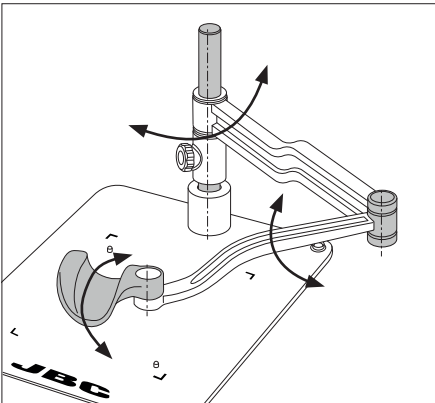

Position the arm and tighten the knobs.

The correct hand work position is shown in the following images:

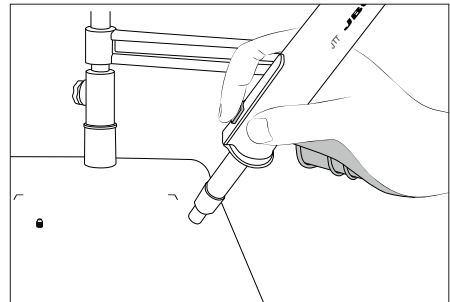
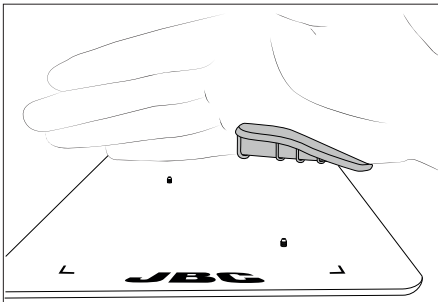

Preheater Positioning

RHN has been designed to work together with PHN

Fit PHN onto the positioning bolts (1) for a proper alignment. The four corner guides (2) help to place the heater unit in its position.

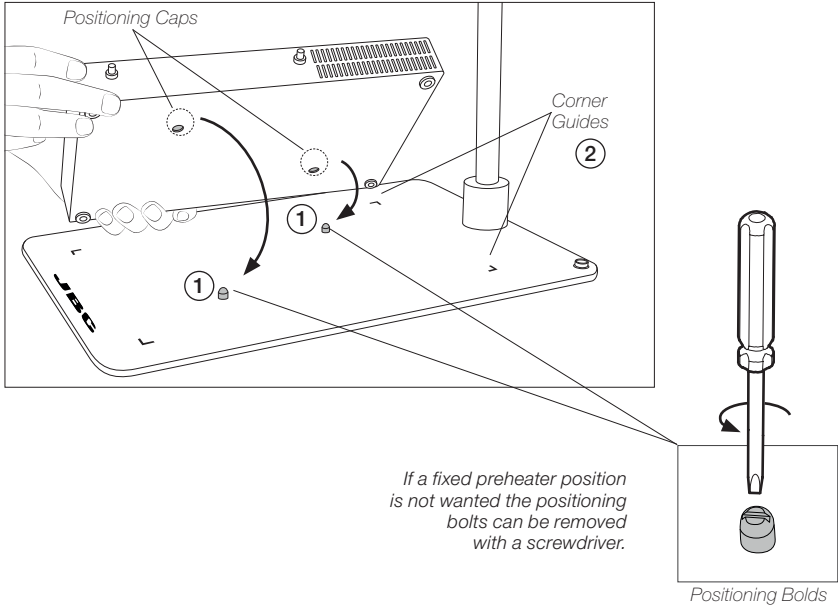

Note: For each preheater size there are different rework hand supports with different base dimensions available.

Preheater	Rework Hand Support	Base Dimension
PHNK	RHN	310 x 239 mm / 12.20 x 9.41 in
PHNS	RHS	400 x 270 mm / 15.75 x 10.63 in
PHNB	RHB	550 x 480 mm / 21.65 x 18.90 in

Accessories*

If a second hand support is needed, Left Hand Support HRL is available. HRL also allows adjustment for different positions.

HRL
Left Hand Support

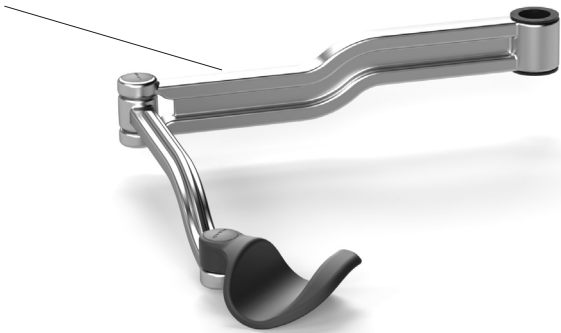

In case of using both left and right arms, assemble both as shown in the illustration according to the letters on the back of the hand support, to keep the hand supports at the same level.

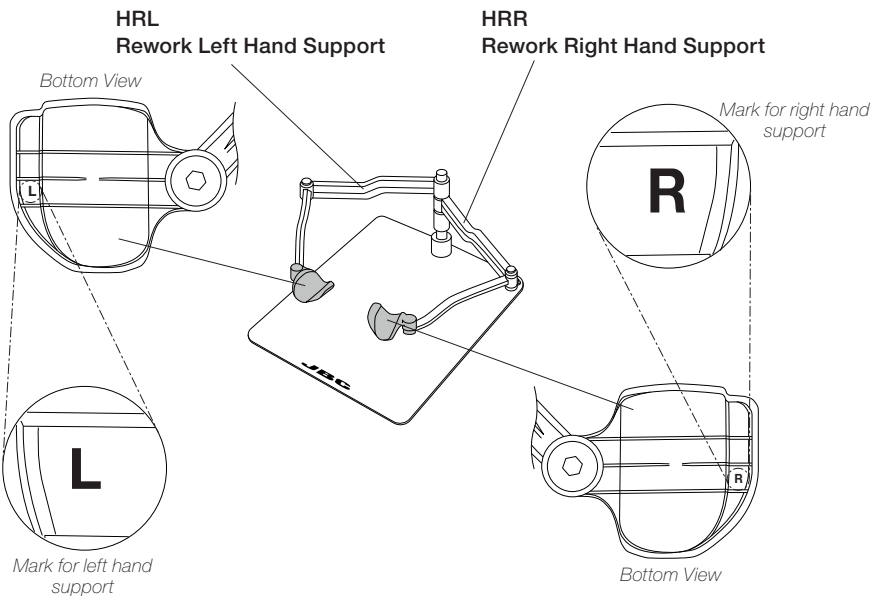

* Not included, sold separately.

Compatible JBC Articles*

HRR and HRL can be combined with RWT, RWS or RWB.

Assemble first the height adjustment flange (1), then the HRR (2) and afterwards the HRL (3). Assemble the second height adjustment flange (4) and finally the RWT (5).

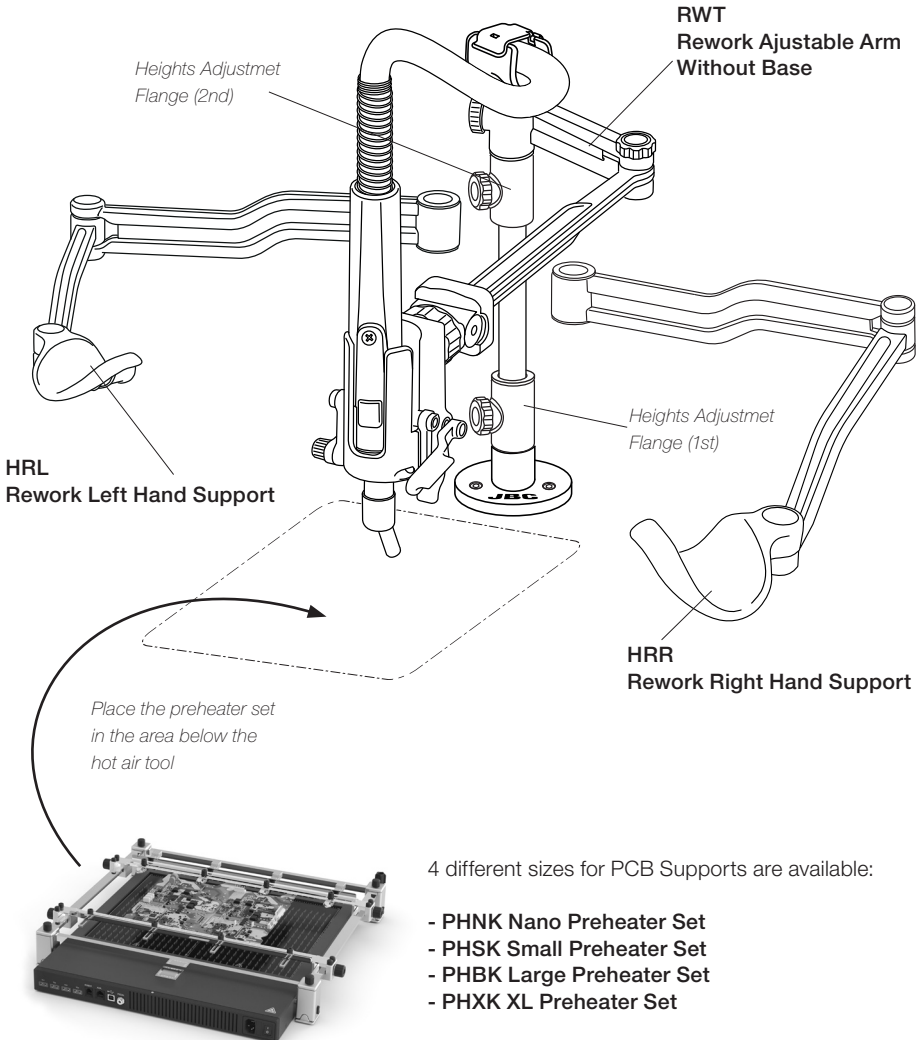

* Not included, sold separately.

Maintenance

- Check periodically that RHN is clean, especially the sliding parts and the shaft.
- Use a damp cloth when cleaning. Alcohol can only be used to clean the metal parts.
- Replace any defective damaged parts. Use original JBC spare parts only.

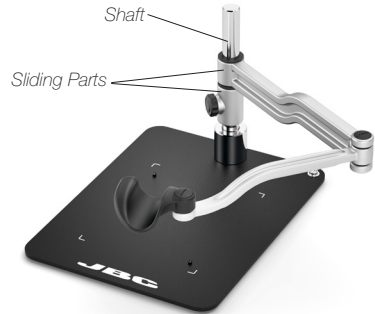
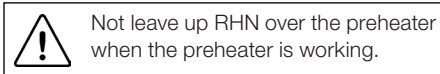

Safety



It is imperative to follow safety guidelines to prevent electric shock, injury, fire or explosions.

- Do not use the equipment for any purpose other than PCB rework.
- The temperature of accessible surfaces may remain high after the unit is turned off. Handle with care.
- Be careful with the fumes produced when soldering.
- Keep your workplace clean and tidy. Wear appropriate protection glasses and gloves when working to avoid personal harm.
- Not leave up the arms directly above heat surfaces.
- Utmost care must be taken with liquid tin waste which can cause burns.
- This appliance can be used by children over the age of eight as well as persons with reduced physical, sensory or mental capabilities or lacking experience provided that they have been given adequate supervision or instruction concerning use of the appliance and understand the hazards involved. Children must not play with the appliance.
- Maintenance must not be carried out by children unless supervised.

Notes

This image shows a single sheet of white paper with horizontal ruling lines. The lines are evenly spaced and run across the width of the page. There are no margins, text, or other markings on the paper.

Notes

[illegible]

Notes

This image shows a single sheet of white paper with horizontal ruling lines. The lines are evenly spaced and run across the width of the page. There are no margins, text, or other markings on the paper.

Specifications

RHN

Rework Hand Support for PHNK

Ref.: RHN-A

- Base Dimensions: 310 x 239 mm / 12.20 x 9.41 in
- Total Height: 205 mm / 8.07 in
- Arm Height: 200 mm / 7.87 in
- Arm Length: 498 mm / 19.61 in
- ESD Connector
- Total Net Weight: 4.50 kg / 9.92 lb
- Package Dimension / Weight: 370 x 204 x 370 mm / 6.09 kg
(L x W x H) 14.57 x 8.03 x 14.57 in / 13.43 lb

Complies with CE standards

ESD Safe

JBC

Warranty

JBC's 2 year warranty covers this equipment against all manufacturing defects, including the replacement of defective parts and labour.

Warranty does not cover product wear or misuse.

In order for the warranty to be valid, equipment must be returned, postage paid, to the dealer where it was purchased.



This product should not be thrown in the garbage.

In accordance with the European directive 2012/19/EU, electronic equipment at the end of its life must be collected and returned to an authorized recycling facility.

